

Hammer®

User Manual

Translation

Planer-Thicknesser A3-26 / A3-31 / A3-41

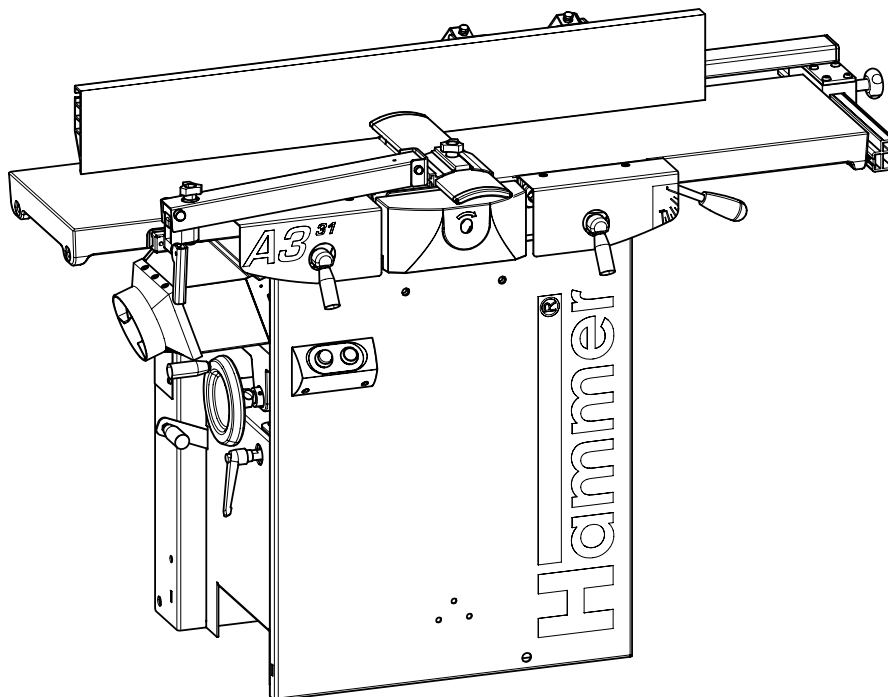

Keep this manual handy and in good condition for continual reference



Note: Year of construction

The machine number of this machine will be printed on this operating manual
The final two digits of the machine number show the year of construction of this machine
e.g. XXX.XX.XXX.10 -> Year of manufacture 2010



Attention!

The machine must be inspected immediately upon arrival. If the machine has been damaged during transport, or if any parts are missing, a written record of the problems must be submitted to the forwarding agent and a damage report compiled. Also be sure to notify your supplier immediately.



For the safety of all personnel, it is necessary to conscientiously study this manual before assembly and operation. This manual must be kept in good condition, and should be considered as part of the machine. Furthermore, the manual must be kept to hand and within the vicinity of the machine so that it is accessible to operators when using, maintaining or repairing the machine.

HAMMER | **A product of the FELDER GROUP**

© **Felder KG**

KR-FELDER-STR. 1

A-6060 Hall in Tirol

Tel.: +43 (0) 5223 / 45 0 90

Fax.: +43 (0) 5223 / 45 0 99

E-Mail: info@hammer.at

Internet: www.hammer.at

Table of contents

1 General	6
1.1 Symbol legend.....	6
1.2 Information about the manual	6
1.3 Liability and warranty	7
1.4 Copyright.....	7
1.5 Warranty notice.....	7
1.6 Spare parts	7
1.7 Disposal.....	8
2 Safety	9
2.1 Intended use	9
2.2 Manual contents	9
2.3 Making changes and modifications to the machine.....	9
2.4 Responsibilities of the operator.....	10
2.5 Personnel requirements.....	10
2.6 Work safety	10
2.7 Personal protective equipment	11
2.8 Machine hazards	11
2.9 Other risks	12
3 Declaration of Conformity	13
4 Technical specifications.....	14
4.1 Dimensions and weight.....	14
4.2 Electrical connection	14
4.3 Drive motor	15
4.4 Chip extraction	15
4.5 Operation and storage conditions	15
4.6 Particle emission	15
4.7 Noise emission	16
4.7.1 Surface planing	16
4.7.2 Thickness planing.....	16
4.8 Cutterblock.....	17
4.9 Planer unit.....	17
4.10 Thicknesser unit.....	17
4.11 Drilling unit	17
5 Assembly	18
5.1 Overview	18
5.2 Accessories	19
5.3 Data plate.....	21
5.4 Safety devices	22
5.4.1 Safety break switches	22
5.4.2 Bridge guard.....	22
5.4.3 Rear cutterblock cover.....	23
5.4.4 Kickback guards	23
5.4.5 Drilling chuck guard	23
5.5 Operation and display elements.....	24

6 Transport, packaging and storage	25
6.1 Safety instructions	25
6.2 Transport.....	25
6.3 Transport inspection.....	27
6.4 Packaging	27
6.5 Storage.....	27
7 Setup and installation	28
7.1 Safety instructions	28
7.2 Setup.....	28
7.3 Chip extraction	30
7.4 Electrical connection	31
7.4.1 Alternating-current motor	31
7.4.2 Three-phase alternating current motor	31
8 Making adjustments and preparations.....	32
8.1 Safety instructions	32
8.2 Adjusting the depth of cut.....	32
8.3 Adjusting the joint	33
8.4 Adjusting the planer fence.....	34
8.4.1 Adjusting the angle	34
8.4.2 Sliding.....	34
8.5 Adjust the thicknessing height	35
8.6 Adjusting the drilling support	36
8.7 Retooling from a planer to a thicknesser	37
8.8 Retooling from a thicknesser to a planer	38
8.9 Retooling to the drilling unit	39
8.9.1 Mounting the mortising support.....	39
8.9.2 Clamp the drilling tool	39
8.10 Retooling from a drilling operation to a planer or a thicknesser operation.....	40
9 Operation	41
9.1 Safety instructions	41
9.2 Switching on the machine	42
9.3 Switching off the machine / EMERGENCY-STOP	42
9.4 Surface planing	43
9.4.1 Working position	43
9.4.2 Workpiece dimensions	43
9.4.3 Authorised and prohibited work techniques	43
9.4.4 Surface planing - Workpieces up to 75 mm thick	44
9.4.5 Surface planing - Workpieces over 75 mm thick.....	45
9.4.6 Jointing.....	46
9.4.7 Bevelling/Chamfering.....	47
9.4.8 Tapering/beveling small workpieces.....	48
9.5 Thickness planing.....	48
9.5.1 Workpiece dimensions	48
9.5.2 Authorised and prohibited work techniques	48
9.5.3 Work place/work position	49

Table of contents

9.6 Drilling	50
9.6.1 Work place/work position	50
9.6.2 Workpiece dimensions	50
9.6.3 Authorised and prohibited work techniques	50
9.6.4 Drilling with/without a depth fence.....	51
9.6.5 Mortising	51
10 Service	52
10.1 Safety instructions	52
10.2 Maintenance schedule	52
10.3 Maintenance work	53
10.3.1 Checking/cleaning the kickback guards.....	53
10.3.2 Cleaning the feed rollers	53
10.3.3 Greasing the height spindle (thicknesser planing table)	54
10.3.4 Retensioning the drive belt.....	54
10.3.5 Replacing the drive belt.....	55
10.3.6 Checking/greasing the chain (transmission).....	56
10.3.7 Checking/changing the friction wheel (transmission).....	56
10.3.8 Greasing the height spindle (drilling support).....	57
10.3.9 Cleaning the guides (drilling support)	57
11 Faults	58
11.1 Safety instructions	58
11.2 What to do if a fault develops	58
11.3 What to do after rectifying the fault.....	58
11.4 Faults, causes and repairs	59
11.5 Resharpen or replace the planer knife	60
11.5.1 Reversing/replacing the system planer blades.....	61
11.5.2 Sharpening/changing the standard planer knives	62
11.6 Correcting the angle of the planing fence.....	63
12 Index	66

1 General

1.1 Symbol legend

Important technical safety instructions in this manual are marked with symbols.
These instructions for work safety must be followed.

In all these particular cases, special attention must be paid in order to avoid accidents, injury to persons or material damage.



Warning! Risk of injury or death

This symbol marks instructions that must be followed in order to avoid harm to one's health, injuries, permanent impairment or death.



Attention! Risk of material damage!

This symbol marks instructions which, if not observed, may lead to material damage, functional failures and/or machine breakdown.



Warning! Danger! Electric current!

This symbol warns of potentially dangerous situations related to electric current. Not observing the safety instructions increases the risk of serious injury or death. All electrical repairs must be carried out by a qualified electrician.



Note:

This symbol marks tips and information which should be observed to ensure efficient and failure-free operation of the machine.

1.2 Information about the manual

This manual describes how to operate the machine properly and safely. Be sure to follow the safety tips and instructions stated here as well as any local accident prevention regulations and general safety regulations. Before beginning any work on the machine, ensure that the manual, in particular the chapter entitled "Safety" and the respective safety guidelines, has been read in its

entirety and fully understood. This manual is an integral part of the machine and must therefore be kept in the direct vicinity of the machine and be accessible at all times. If the machine is sold, rented, lent or otherwise transferred to another party, the manual must accompany the machine.

1.3 Liability and warranty

The contents and instructions in this manual were compiled in consideration of current regulations and state-of-the-art technology as well as based on our know-how and experience acquired over many years. This manual must be read carefully before commencing any work on or with this machine. The manufacturer shall not be liable for damage and or faults resulting from the disregard of instructions in the manual. The texts and images do not necessarily represent the delivery contents. The images and graphics are not depicted on

a 1:1 scale. The actual delivery contents are dependent on custom-build specifications, add-on options or recent technical modifications and may therefore deviate from the descriptions, instructions and images contained in the manual. Should any questions arise, please contact the manufacturer. We reserve the right to make technical modifications to the product in order to further improve user-friendliness and develop its functionality.

1.4 Copyright

This manual should be handled confidentially. It is designated solely for those persons who work on or with the machine. All descriptions, texts, drawings, photos and other depictions are protected by copyright and other commercial laws. Illegal use of the materials is punishable by law.

This manual, in its entirety or parts thereof, may not be transferred to third parties or copied in any way or

form, and its contents may not be used or otherwise communicated without the express written consent of the manufacturer.

Infringement of these rights may lead to a demand for compensation or other applicable claims. We reserve all rights in exercising commercial protection laws.

1.5 Warranty notice

A separate warranty notice, which conforms to the specific regulations of the respective country, is enclosed.

1.6 Spare parts



Attention! Risk of material damage!

Non genuine, counterfeit or faulty spare parts may result in damage, cause malfunction or complete breakdown of the machine.

If unauthorised spare parts are fitted into the machine, all warranty, service, compensation and liability claims against the manufacturer and their contractors, dealers and representatives shall be rejected.

Use only genuine spare parts supplied by the manufacturer.



Note: The original spare parts that have been authorised for use are listed in a separate spare parts catalogue, enclosed in the documentation package supplied with the machine.

1.7 Disposal

If the machine is to be disposed of, separate the components into the various materials groups in order to allow them to be reused or selectively disposed of. The whole structure is made of steel and can therefore be dismantled without difficulties.

This material is also easy to dispose of and does not

pollute the environment or jeopardise public health. Always comply with international environmental regulations and local disposal laws.



Attention! Used electrical materials, electronic components, lubricants and other auxiliary substances must be treated as hazardous waste and may only be disposed of by specialised, licensed firms.

2 Safety

At the time of its development and production, the machine was built in accordance with prevailing technological regulations and therefore conforms to industry safety standards.

However, hazards may arise should the machine be operated by untrained personnel, used improperly or employed for purposes other than those it was designed for. The chapter entitled "Safety" offers an overview of all the important safety considerations necessary to

optimise safety and ensure the safe and trouble-free operation of the machine.

To further minimise risks, the other chapters of this manual contain specific safety instructions, all marked with symbols. Besides the various instructions, there are a number of pictograms, signs and labels affixed to the machine that must also be heeded. These must be kept visible and must not be removed.

2.1 Intended use

The planer-thicknesser HAMMER A3-26, A3-31, A3-41 has been designed solely for surface planing, thickness planing and mortising wood and similarly machinable materials. Machining materials other than wood is

only permitted with the express written consent of the manufacturer. Operational safety is guaranteed only when the machine is used for the intended purposes.



Attention! Any use outside of the machine's intended purpose shall be considered improper and is therefore not permitted. All claims regarding damage resulting from improper use that are made against the manufacturer and its authorised representatives shall be rejected. The operator shall be solely liable for any damage that results from improper use of the machine.

The term "proper use" also refers to correctly observing the operating conditions as well as the specifications and instructions in this manual.

The machine may only be operated with original manufacturer parts and accessories.

2.2 Manual contents

All those appointed to work on or with the machine must have fully read and understood the manual before commencing any work. This requirement must be met even if the appointed person is familiar with the operation of such a machine or a similar one, or has been trained by the manufacturer.

Knowledge about the contents of this manual is a

prerequisite for protecting personnel from hazards and avoiding mistakes so that the machine may be operated in a safe and trouble free manner. It is recommended that the operator requests proof from the personnel that the contents of the manual have been read and understood.

2.3 Making changes and modifications to the machine

In order to minimise risks and to ensure optimal performance, it is strictly prohibited to alter, retrofit or modify the machine in any way without the express consent of the manufacturer.

All the pictograms, signs and labels affixed to the

machine must be kept visible, readable and may not be removed. Pictograms, signs and labels that have become damaged or unreadable must be replaced promptly.

2.4 Responsibilities of the operator

This manual must be kept in the immediate vicinity of the machine and be accessible at all times to all persons working on or with the machine. The machine may only be operated if it is in proper working order and in safe condition. The general condition of the machine must be controlled and the machine must be inspected for visible defects every time before it is switched on. All instructions in this manual must be strictly followed without reservation.

Further to the safety advice and instructions stated in this manual, it is necessary to consider and observe

local accident prevention regulations, general safety regulations and current environmental stipulations that apply to the operational range of the machine. The operator and designated personnel are responsible for the trouble-free operation of the machine as well as for clearly establishing who is in charge of installing, servicing, maintaining and cleaning the machine. Machines, tools and accessories must be kept out of the reach of children.

2.5 Personnel requirements

Only authorised and trained personnel may work on and with the machine. Personnel must be briefed about all functions and potential dangers of the machine. "Specialist staff" is a term that refers to those who – due to their professional training, know-how, experience, and knowledge of relevant regulations – are in a position to assess delegated tasks and recognise potential risks. If the personnel lack the necessary knowledge for working on or with the machine, they must first be trained. Responsibility for working with the machine (installation, service, maintenance, overhaul) must be clearly defined and strictly observed. Only those persons who can be expected to carry out their work reliably may be given permission to work on or with the machine. Personnel

must refrain from working in ways that could harm others, the environment or the machine itself. It is absolutely forbidden for anyone who is under the influence of drugs, alcohol or reaction-impairing medication to work on or with the machine. When appointing personnel to work on the machine, it is necessary to observe all local regulations regarding age and professional status. The user is also responsible for ensuring that unauthorised persons remain at a safe distance from the machine. Personnel are obliged to immediately report any irregularities with the machine that might compromise safety to the operator.

2.6 Work safety

Following the safety advice and instructions given in this manual can prevent bodily injury and material damage while working on and with the machine. Failure to observe these instructions can lead to bodily injury and damage to or destruction of the machine. Disregard of the safety advice and instructions given in this manual

as well as the accident prevention regulations and general safety regulations applicable to the operative range of the machine shall release the manufacturer and their authorised representatives from any liability and from all compensation claims.

Safety

2.7 Personal protective equipment

When working on or with the machine, the following must be strictly observed:



Persons with long hair who are not wearing a hairnet are not permitted to work on or with the machine!



It is prohibited to wear gloves while working on or with the machine!

When working on or with the machine, the following must always be worn by personnel:



Protective clothes

Sturdy, tight-fitting clothing (tear-resistant, no wide sleeves).



Protective footwear

that protect the feet from heavy falling objects and prevent sliding on slippery floors



Hearing protection

To protect against loss of hearing

2.8 Machine hazards

The machine has undergone a hazard analysis. The design and construction of the machine are based on the results of this analysis and correspond to state-of-the-art technology.
The machine is considered operationally safe when used

properly.
Nevertheless, there are some remaining risks that must be considered.
The machine runs with high electrical voltage.



Warning! Danger! Electric current:

Electrical energy can cause serious bodily injury. Damaged insulation materials or defective individual components can cause a life-threatening electrical shock.

- Before carrying out any maintenance, cleaning and repair work, switch off the machine and ensure that it can not be accidentally switched on again.
- When carrying out any work on the electrical equipment, ensure that the voltage supply is completely isolated.
- Do not remove any safety devices or alter them to prevent them from functioning correctly.

2.9 Other risks



Warning! Risk of injury!

Even if the safety measures are complied with, there are still certain associated risks that must be considered when working on the machine:

- Risk of injury when changing the planer knives
- Risk of injury through accidental contact with the rotating cutterblock
- Risk of injury due to ejected workpieces
- Risk of injury from workpiece kickback. (when surface planing)
- Hearing damage as a result of high noise levels
- Health impairments due to the inhalation of airborne particles, especially when working with beech and oak wood.

Declaration of Conformity

3 Declaration of Conformity



EG-Declaration of Conformity
according to Machine Guidelines 2006/42/EG

We hereby declare that the machine indicated below, which corresponds to the design and construction of the model we placed on the market, conforms with the health and safety requirements as stated by the EC.

Manufacturer:	Felder KG KR-FELDER-STR. 1 A-6060 Hall in Tirol
Product designation:	Planer-Thicknesser
Make:	HAMMER
Model designation:	A3-26 / A3-31 / A3-41
The following EC guidelines were applied:	2006/42/EG 2006/95/EG 2004/108/EG
The following harmonised norms were applied:	EN 861
The prototype test was carried out by:	Fachausschuss Holz Prüf- und Zertifizierungsstelle im BG-Prüfzert Vollmoellerstraße 11 D-70563 Stuttgart NB 0392
Conformity with the EC Machine Guidelines certified by:	EG-Design Test Certificate No. HO 101055

This EC Declaration of Conformity is valid only if the CE label has been affixed to the machine.

Modifying or altering the machine without the express written agreement of the manufacturer shall render the warranty null and void.

The signatory of this statement is the appointed agent for the compilation of the technical information

Hall in Tirol, 1.1.2010

A handwritten signature in black ink, which appears to read 'Johann Felder'.

Johann Felder, Managing Director FELDER KG
KR-FELDER-STR. 1 • A-6060 Hall in Tirol

4 Technical specifications

4.1 Dimensions and weight

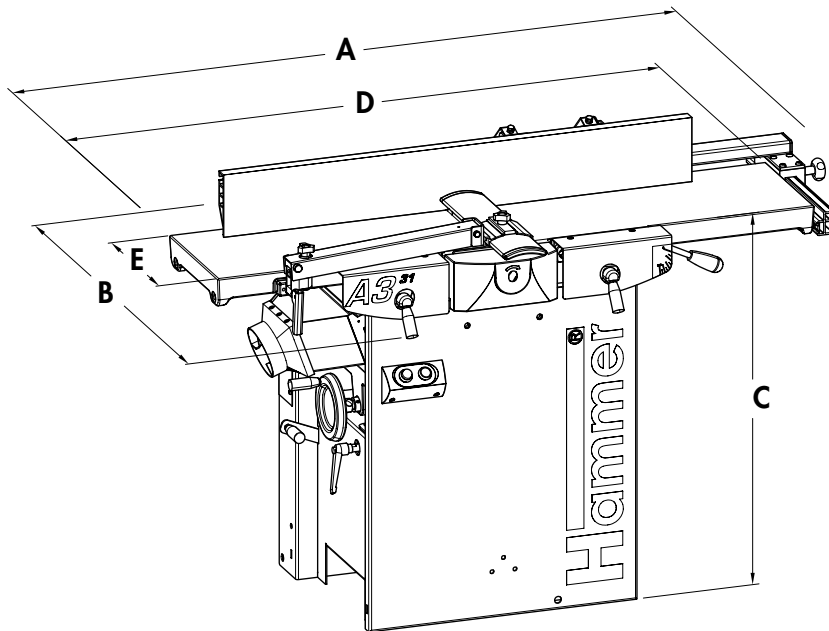

Fig. 4-1: Dimensions

Machine	A3-26	A3-31	A3-41
Total length (A)	1255 mm	1535 mm	1933 mm
Overall width (B)	740 mm	790 mm	890 mm
Working height - Planer tables (C)	850 mm	850 mm	850 mm
Total planer table length (D)	1120 mm	1400 mm	1800 mm
Surface planing width (E)	260 mm	310 mm	410 mm
Weight	195 kg	240 kg	295 kg

Machine including packaging	A3-26	A3-31	A3-41
Length	1160 mm	1410 mm	1810 mm
Width *)	540 mm	580 mm	770 mm
Height	1090 mm	1090 mm	1090 mm
Weight	255 kg	300 kg	355 kg

*) The transport width measures under 800 mm. This makes it possible to transport the machine through doorways.

4.2 Electrical connection

Mains voltage	230/400 ±10% V
Safeguarding	16 A
triggering characteristic	C

Technical specifications

4.3 Drive motor

The actual values can be found on the data plate.

	Alternating-current motor	Three-phase current motor
Motor voltage	1x 230 V	3x 400 V
Motor frequency	50/60 Hz	50/60 Hz
Motor power A3-26 S6-40 % ^{*)}	1,9 kW	–
Motor power A3-31 S6-40 % ^{*)}	3,0 kW	3,0 kW
Motor power A3-41 S6-40 % ^{*)}	3,0 kW	4,0 kW
System of protection	IP 55	IP 55

^{*)} S6 = 10 minute operation under load and intermittent service; 40% = relative operating factor, i.e. the motor may be run at the nominal capacity for 4 minutes and afterwards must run idle for 6 minutes.

4.4 Chip extraction

	A3- 26	A3-31 / A3-41	Drilling unit
Extractor port diameter	100 mm	120 mm	120 mm
Air speed	20 m/s	20 m/s	20 m/s
Vacuum, min.	740 Pa	740 Pa	855 Pa
Volume flow, min. (at 20 m/s)	565 m ³ /h	814 m ³ /h	814 m ³ /h

4.5 Operation and storage conditions

Operating/room temperature	+10° to +40° C
Storage temperature	–10° to +50 °C



Attention! Risk of material damage!

**Only operate the machine in ambient temperatures from +10° to +40° C.
If the instructions are not followed, damage may occur during storage.**

4.6 Particle emission

The machine was tested for particle emissions according to DIN 33893. The Wood Authority ascertained, according to the "Principles for Testing Particle Emissions" (workplace-related particle concentrations) of

woodworking machines, that the particle emission values for this machine are notably below the currently valid atmospheric limit of 2.0 mg/m³. This is certified by the blue label "BG Wood Particle Tested".

4.7 Noise emission

The specified values are emission values and therefore do not represent safe workplace values. Even though a relationship exists between particle emission and noise emission levels, an inference cannot be made about whether additional safety measures need to be implemented. Factors which can significantly affect the emission level that presently exists at the workplace include duration of the effect, characteristics

of the workspace, and other ambient influences. The permissible workplace values may also differ from country to country. Nevertheless, this information is provided to help the operator better assess hazards and risks. Depending on the location of the machine and other specific conditions, the actual noise emission values may deviate significantly from the specified values.



Note:

In order to keep noise emission to a minimum, be sure to always use sharpened planer knives.

Ear protection must always be worn; however, such protection cannot be considered a substitute for properly sharpened tools.

An allowance must be made to compensate for tolerances with the specified emission values $K = 4 \text{ dB (A)}$.

4.7.1 Surface planing

Acoustic power level according to EN ISO 3746

Idle	89,3 dB (A)
Working	100,0 dB (A)

Emission values at the workplace according to EN ISO 11202

Idle	84,7 dB (A)
Working	90,3 dB (A)

4.7.2 Thickness planing

Acoustic power level according to EN ISO 3746

Working position 1 (feeder-side)

Idle	89,3 dB (A)
Working	98,5 dB (A)

Emission values at the workplace according to EN ISO 11202

Working position 1 (feeder-side)

Idle	75,2 dB (A)
Working	89,8 dB (A)

Working position 2 (receiver-side)

Idle	71,5 dB (A)
Working	89,0 dB (A)

Technical specifications

4.8 Cutterblock

Cutterblock diameter (knife flight)-Ø	72 mm
Number of knives	3
Speed 50/60 Hz	5000/6000 min ⁻¹

4.9 Planer unit

	A3-26	A3-31	A3-41
Maximum depth of cut	4 mm	4 mm	4 mm
Surface planing width	260 mm	310 mm	410 mm
Planer table length	540 mm	628/730 mm	880 mm
Total planer table length	1120 mm	1400 mm	1800 mm
Length of surface planer fence	150 x 750 mm	150 x 1100 mm	150 x 1100 mm
Planer fence, tiltable from	90° to -45°		

4.10 Thicknesser unit

	A3-26	A3-31	A3-41
Thicknessing width	254 mm	304 mm	404 mm
Thicknesser table length	540 mm	540 mm	600 mm
Thicknessing height, min./max.	4/225 mm	4/225 mm	4/225 mm
Feeder	6,5 m/min	6,5 m/min	6,5 m/min



Note:

The maximum depth of cut is directly related to the following factors:

- Panel width Panel intensity
- Type of wood (hardwood or softwood)
- Wood dampness
- Feed rate
- Planer knives (SS, HS, HW)
- The motor power of your machine

4.11 Drilling unit

2-jaw drilling chuck	1–16 mm
Mortising table	
Height adjustment ^{*)}	135 mm
Longitudinal adjustment ^{*)}	200 mm
Depth adjustment ^{*)}	130 mm

^{*)} Measured from the middle of the cutterblock/drilling tool and the front edge of the drilling chuck guard.

5 Assembly

5.1 Overview

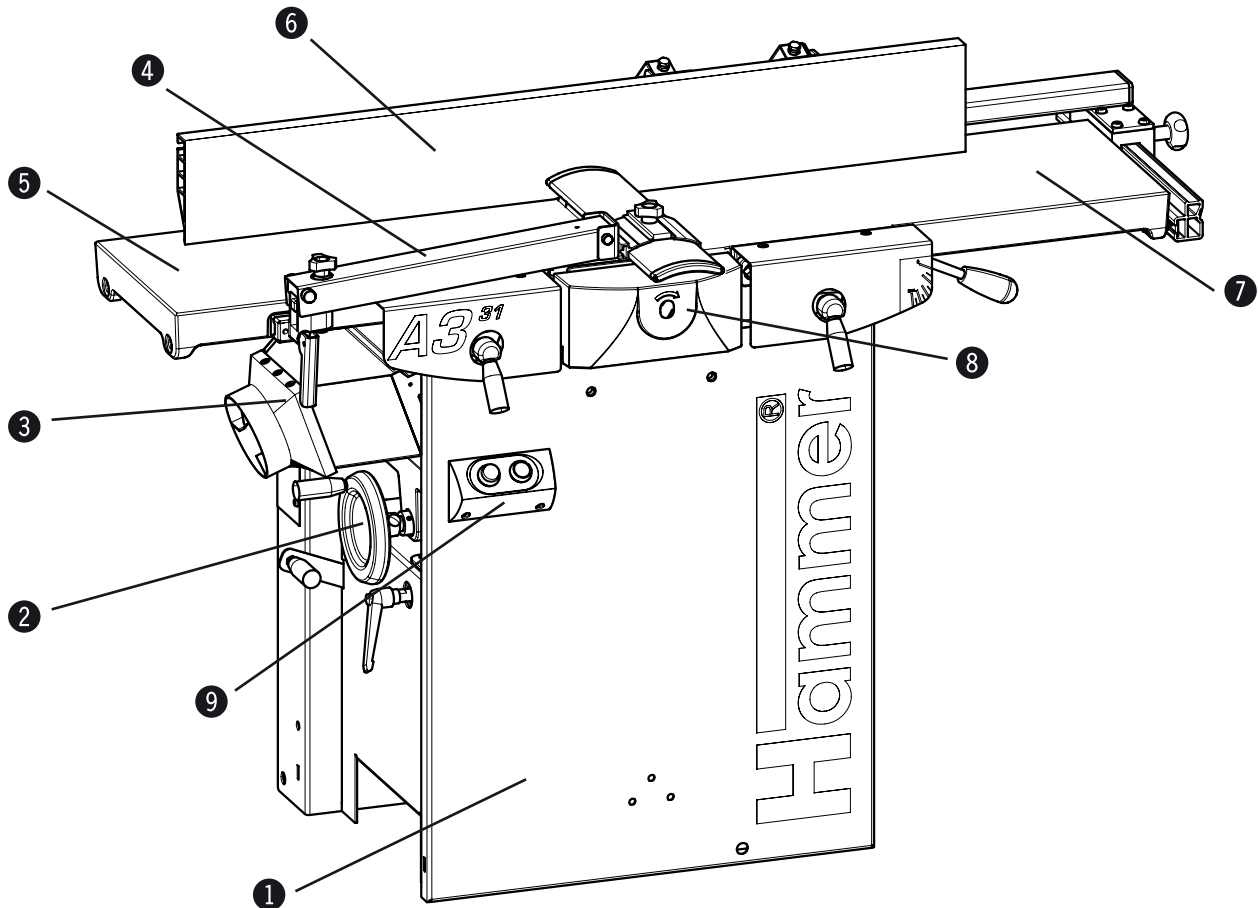

Fig. 5-1: Overview

- ① Housing with drive motor and gearbox
- ② Thicknesser unit
- ③ Vacuum hood with vacuum connector
- ④ Bridge guard
- ⑤ Planer table, receiver-side
- ⑥ Combination fence (with rear cover for the cutterblock)
- ⑦ Planer table, feeder-side
- ⑧ Cutterblock with thread for mortising chuck
- ⑨ Switching point

5.2 Accessories

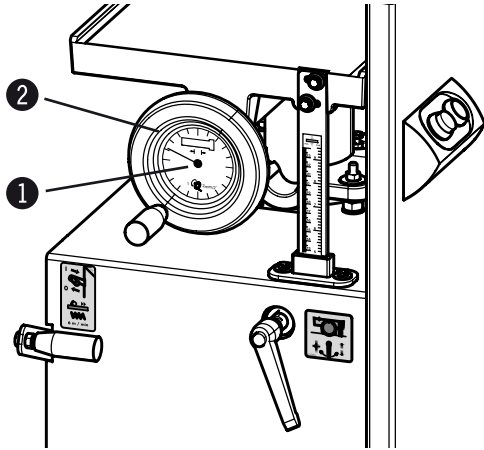

Fig. 5-2: Digital clock

System handwheel

Art. No. 12.1.311

Digital clock

Art. No. 01.1.202 (Display in "mm")

Art. No. 01.2.202 (Display in "inch")

The digital display is built into both the thickening height adjustment system handwheel and the drilling height adjustment system handwheel (drilling support is an add-on option).

Exact adjustments to one tenth of a millimeter are possible with the digital display
(See assembly instructions „Digital clock“)

- ① Digital clock
- ② System handwheel

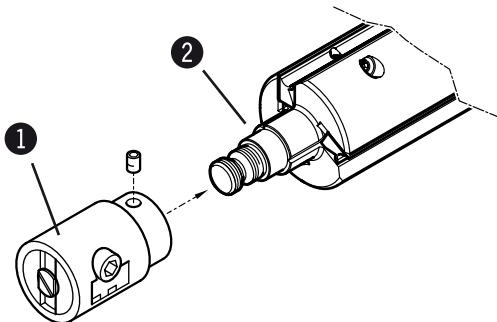

Fig. 5-3: 2-jaw drilling chuck

2-jaw drilling chuck

Art. No. 500-118

The drilling chuck is mounted onto the cutterblock. The mortising chuck holds the mortising tools
(See assembly instructions „Drilling chuck and coupler unit“)

- ① 2-jaw drilling chuck
- ② Cutterblock

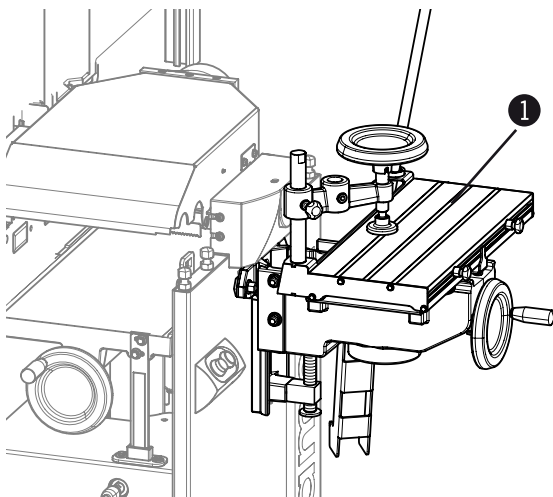

Fig. 5-4: Drilling chuck and coupler unit

Mortising table / Coupler unit

Art. No. 501-117

The coupler unit is mounted onto the machine frame. Hang the mortising support into the coupling device and secure it

(See assembly instructions „Drilling chuck and coupler unit“ and „Mortising table“)

- ① Mortising table

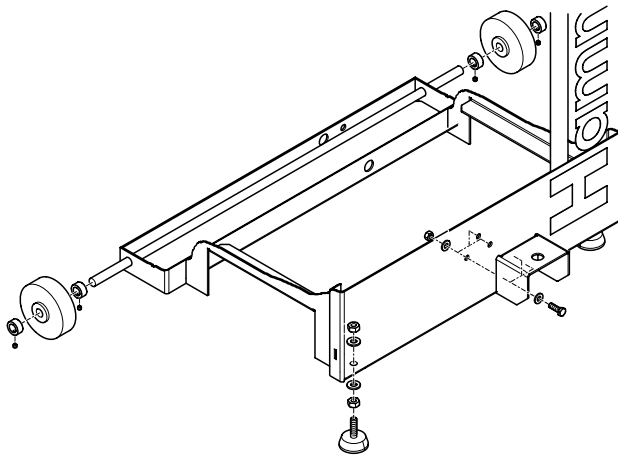

Fig. 5-5: Rolling carriage

Rolling carriage
Art. No. 503-134

Mount the rolling carriage onto the machine housing.
The rolling carriage facilitates the task of positioning the machine
(See assembly instructions „Rolling carriage“)

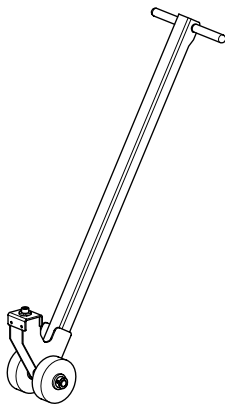

Fig. 5-6: Lifting bar

Lifting bar
Art. No. 500-149

Hook the lifting bar under the rolling carriage coupling (Accessory).
The lifting bar and the rolling carriage facilitate the task of manoeuvring the machine in the most confined space.
(See assembly instructions „Lifting bar“)

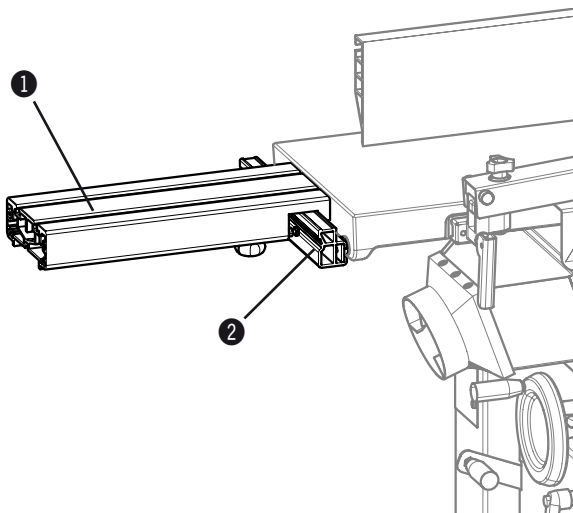

Fig. 5-7: Table extension

HAMMER Mounting rail for table extension

Art. No. 500-157 (260 mm)
Art. No. 500-102 (310 mm)
Art. No. 500-151 (410 mm)

Table extension

500-101 (400x150 mm)
500-151 (800x150 mm)

Mount the table extension onto the planer tables. The table extension is a safe support for longer workpieces
The table can be extended by 400 or 800 mm
(See assembly instructions „Table extension“)

- ① Table extension
- ② Mounting Rail for Table Extension

5.3 Data plate

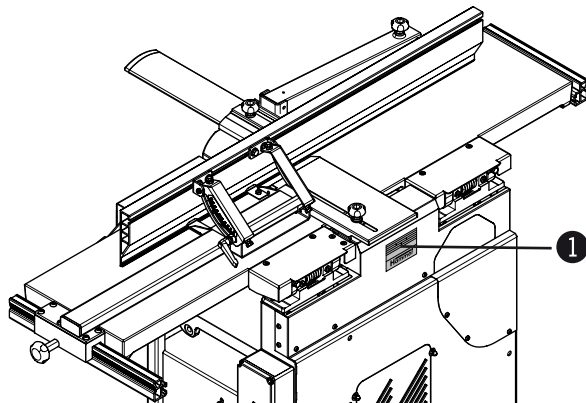

Fig. 5-8: Layout of the data plate

The data plate is found on the back of the machine.

1 Data plate

KR-FELDER-STR.1 A - 6060 HALL in Tirol AUSTRIA Tel.: 0043 (0)5223 / 45 0 90 Fax.: 0043 (0)5223 / 45 0 99			Hammer ® info@hammer.at / www.hammer.at
TYPE :			
NR. :			
V:	PH:	HZ:	
KW:	A:		
Baujahr / year of constr. / annee de constr. :			
Motordaten:			

Fig. 5-9: Data plate

The data plate displays the following specifications:

- Model designation
- Machine number
- Voltage
- Phases
- Frequency
- Power
- Power supply
- Year of construction
- Manufacturer information

5.4 Safety devices

5.4.1 Safety break switches

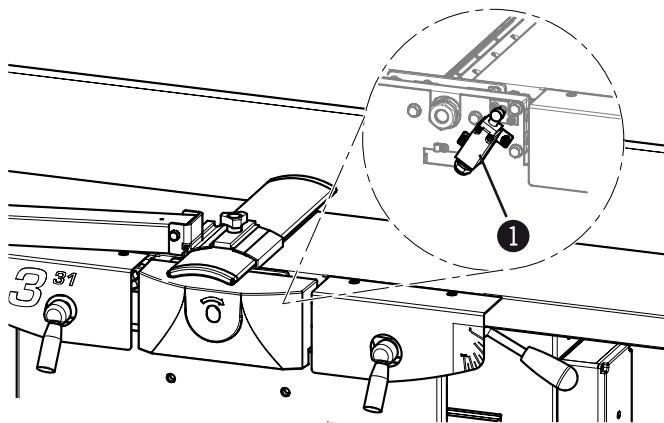

Fig. 5-10: Safety break switches

The cutter block will only run when the safety switch is deactivated by the planer tables or extraction hood.

- ① Break switch for the planer tables

5.4.2 Bridge guard

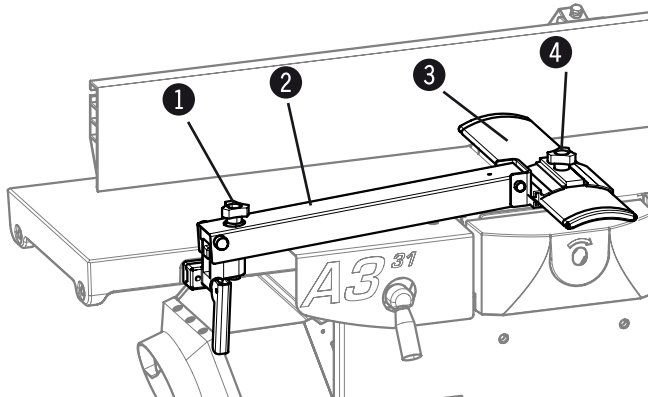

Fig. 5-11: Bridge guard

The bridge guard covers the cutterblock when surface planing.

- ① Setscrew (Height adjustment)
- ② Bridge guard arm
- ③ Protective rail
- ④ Clamping screw (Width adjustment)



Note: Instructions to adjust the bridge guard are given in the respective working techniques descriptions.

5.4.3 Rear cutterblock cover

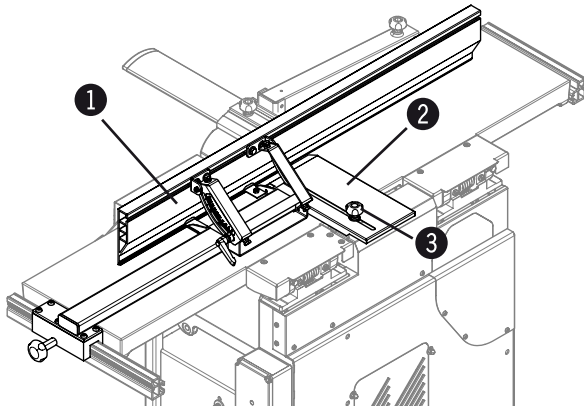

Fig. 5-12 Rear cutterblock cover

When surface planing, the rear cutterblock cover screens the part of the cutterblock that remains exposed behind the fence. Attach the rear cutterblock cover to the back of the combination fence.

The rear cutter block guard is fitted with an additional mount to stabilise the fence.

- ① Planer fence
- ② Cover
- ③ Clamping screw

5.4.4 Kickback guards

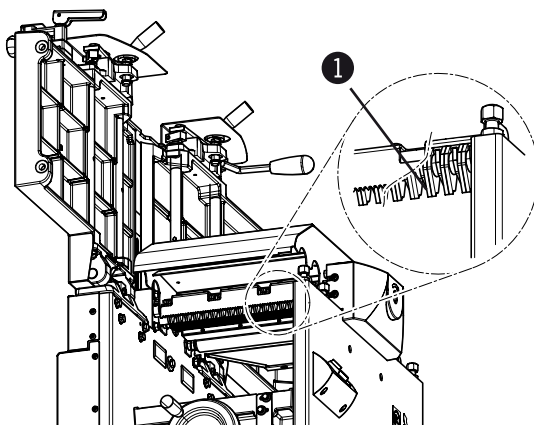

Fig. 5-13: Kickback guards

When thicknessing, the kickback guards prevent the workpiece from kicking back.

- ① Kickback guards



Note: Only properly adjusted (smoothly operating and sharp) kickback guards will perform this protective function! See Chapter >10.3.1 Checking/cleaning the kickback guards<

5.4.5 Drilling chuck guard

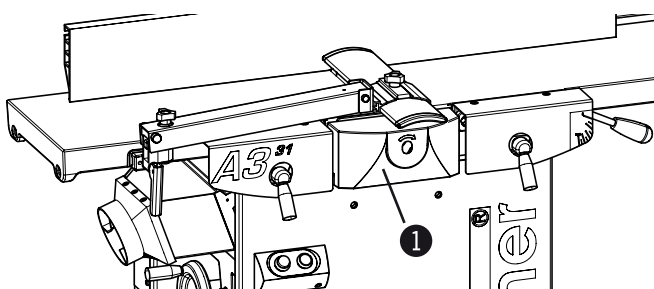

Fig. 5-14: Drilling chuck guard

The drilling chuck guard covers the 2-jaw drilling chuck on the cutterblock.

- ① Drilling chuck guard

5.5 Operation and display elements

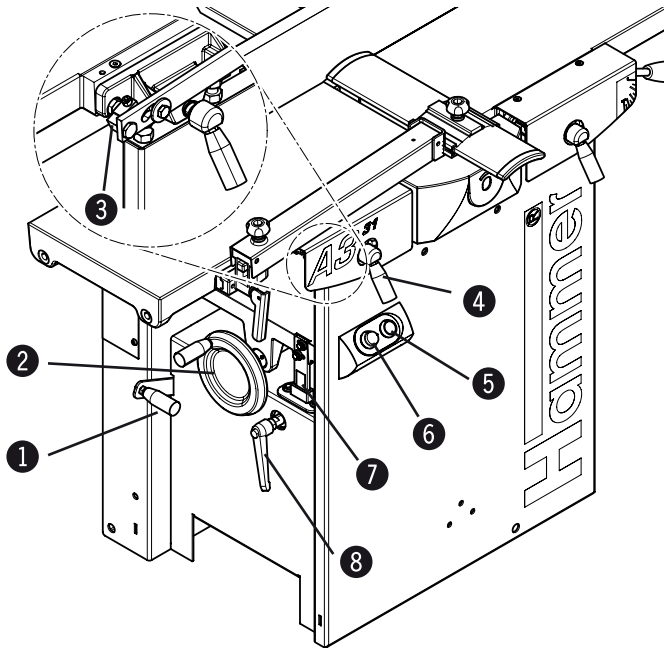

Fig. 5-15: Operation and display elements

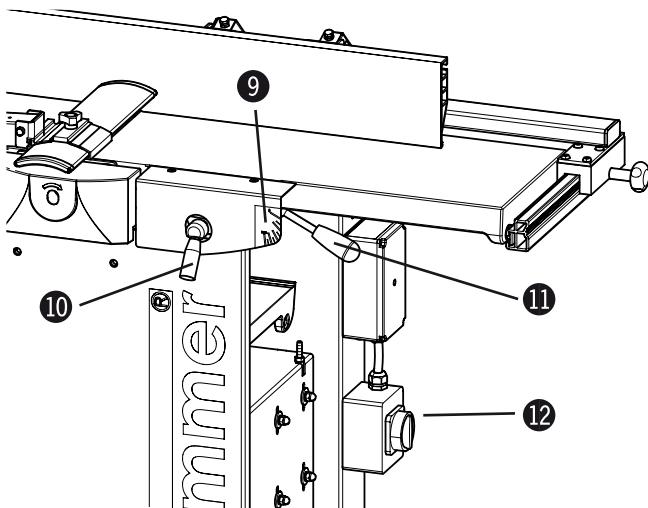

Fig. 5-16: Operation and display elements

- 1 Gear lever**
 - Position O: (pull out)
Surface planing, Jointing, Bevelling/Tapering, mortising and idle machine for a longer period of time
 - Position I: Thickness planing
- 2 System handwheel**
Adjusting the height on the thicknessing unit (Thickness planing height)
- 3 Eccentric (Surface planing)**
Adjusting the height of the receiver side of the planer table
- 4 Single-hand clamping lever**
Clamping the outfeed-side of the planer table
- 5 Green push button**
Switching on the machine
- 6 Red push button**
Emergency stop and switching off the machine
- 7 Scale (Thickness planing)**
Specifying the thicknessing height
- 8 Single-hand clamping lever**
Clamping the planer table
- 9 Scale (Surface planing)**
Specifying the chip thickness on the feeder-side of the planer table
- 10 Single-hand clamping lever**
Clamping the infeed-side of the planer table
- 11 Adjustment handle (Surface planing)**
Adjusting the height of the feeder-side of the planer table
- 12 Main switch (if available)**
 - Position 0: Mains voltage off
 - Position I: Mains voltage on

6 Transport, packaging and storage

6.1 Safety instructions



Warning! Danger! Electric current:

There is a risk of injury as a result of falling parts while transporting, loading or unloading the machine.



Attention! Risk of material damage!

The machine can be damaged or destroyed if it is subjected to improper handling during transport.

For this reason the following safety instructions must be observed:

- Never lift loads over a person.
 - Always move the machine with the utmost care and precaution.
 - Only use suitable lifting accessories and hoisting devices that have a sufficient load-carrying capacity.
 - Never transport the machine by putting pressure on any of its projecting elements (e.g. the planer tables).
 - Consider the machine's centre of gravity when transporting it (minimise the risk of it tipping over).
 - Take measures to prevent the machine from slipping sideways.
 - Ropes, belts or other hoisting devices must be equipped with safety hooks.
 - Do not use torn or worn ropes.
 - Do not use knotted ropes or belts.
 - Ensure that ropes and belts do not lie against sharp edges.
 - Transport the machine as carefully as possible in order to prevent damage.
 - Avoid subjecting the machine to shocks.
- When transporting the machine overseas, ensure that the packaging is airtight and that a desiccant is added to protect the metal parts against corrosion.

6.2 Transport



Attention! Risk of material damage!

Transport the machine according to the enclosed transport and assembly instructions!

Never lift the machine by its planer tables. Ropes, belts and chains may only be fastened to the base of the machine.

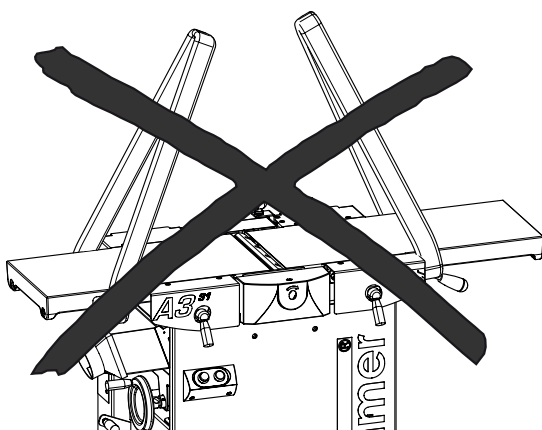

Unless otherwise agreed, the machine is delivered in a partly dismantled state on a pallet.

The machine is dispatched with its joiner tables closed and secured.

Fig. 6-1: It is prohibited to lift the machine by its planer tables!

Transport, packaging and storage

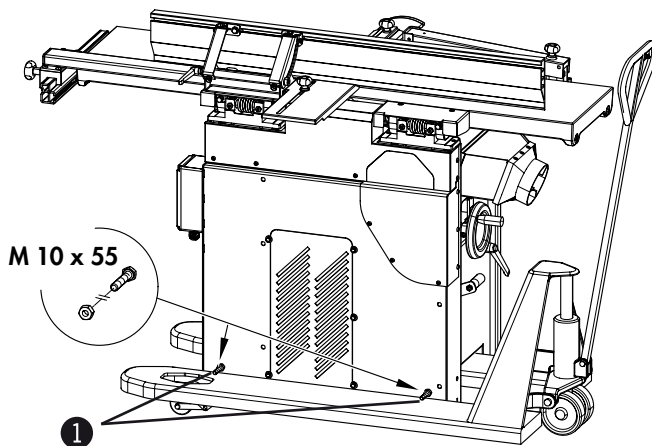

Fig. 6-2: Transport with a pallet jack

The machine can be transported with a crane, forklift, pallet jack or rolling carriage.

When moving the machine with a forklift or pallet jack, bolt the transportation device (option) onto the housing (See assembly instructions „Transport device“).

- 1 Transport device



Warning! Risk of injury!
Remove the transportation device immediately after moving the machine.



Note: The rolling carriage and the lifting bar (option) facilitate the task of transporting the machine.

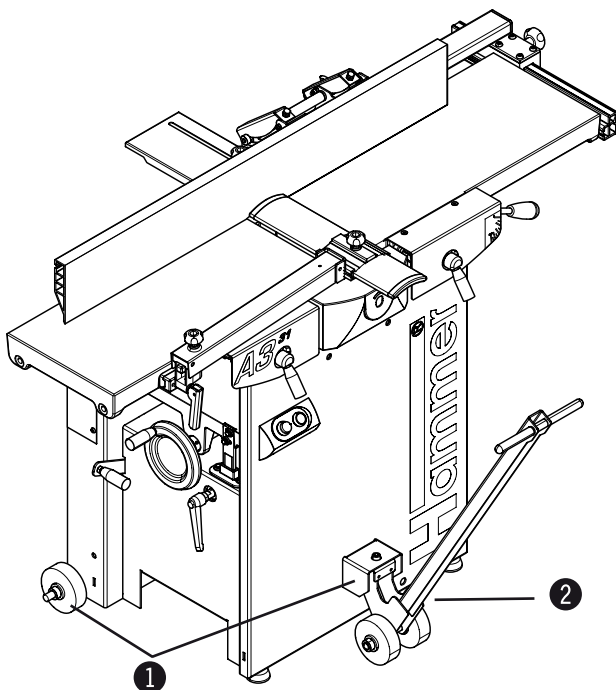

Fig. 6-3: Transport with a rolling carriage

Mount the rolling carriage onto the machine housing.
(See assembly instructions „Rolling carriage“ and „Lifting bar“)

- 1 Rolling carriage
- 2 Lifting bar

6.3 Transport inspection

Upon arrival, inspect the shipment to ensure that it is complete and has not suffered any damage. If any transport damage is visible, do not accept the delivery or only accept it with reservation. Record the scope of the damage on the transport documents/

delivery note. Initiate the complaint process. For all defects that are not discovered upon delivery, be sure to report them as soon as they are recognised as damage claims must be filed within a certain period, as granted by law.

6.4 Packaging

If no agreement has been made with the supplier to take back the packaging materials, help to protect the environment by reusing the materials or separating them according to type and size for recycling.



Attention! Dispose of the packaging materials in an environmentally friendly way and always in accordance with local waste disposal regulations. If applicable, contract a recycling firm to dispose of the packaging materials.



Note: Help preserve the environment! Packaging materials are valuable raw materials and in many cases, they can be used again or expediently reprocessed or recycled.

6.5 Storage

Keep items sealed in their packaging until they are assembled/installed and be sure to observe the stacking and storage symbols on the outside of the packaging.

Store packed items only under the following conditions

- Do not store outdoors.
- Store in a dry and dust-free environment.
- Do not expose to aggressive substances.
- Protect from direct sunlight.
- Avoid subjecting the machine to shocks.
- Storage temperature: -10° to $+50^{\circ}$ °C
- Maximum humidity 60 %
- Avoid extreme temperature fluctuations (condensation build-up)
- Apply a coat of oil to all machine parts open to possible rusting (corrosion protection)
- When storing for a period longer than 3 months, apply a coat of oil to all machine parts open to rusting (corrosion protection) Regularly check the general condition of all parts and the packaging. If necessary, refresh or re-apply the coat of anti-corrosive agent.
- If the machine is to be stored in a damp environment, it must be sealed in airtight packaging and protected against corrosion (desiccant)
- If the machine will not be used for a longer period of time, ensure that the gear lever is positioned on the „0“ setting.

7 Setup and installation

7.1 Safety instructions



Warning! Risk of injury! Improper assembly and installation can lead to serious physical injury or equipment damage. For this reason, this work may only be carried out by authorised, trained personnel who are familiar with how to operate the machine and in strict observance of all safety instructions.

- Ensure that there is sufficient space to work around the machine. It is very hazardous to thickness plane rail-guided workpieces when there is insufficient clearance to neighbouring machines, to walls or to other fixed equipment.
- Keep the work area orderly and clean. Components and tools that are not put in their correct place or put away may be the cause of accidents!
- Install the safety equipment according to the instructions and check that it functions properly.



Warning! Danger! Electric current:
Work on electrical fittings may only be carried out by qualified personnel and in strict observance of the safety instructions.

Before assembling and installing the machine, check to make sure it is complete and in good condition.



Warning! Risk of injury! An incomplete, faulty or damaged machine can lead to serious physical injury or equipment damage. Only assemble and install the machine if the machine and its parts are complete and intact.



Attention! Risk of material damage!
Only operate the machine in ambient temperatures from +10° to +40° C.
If the instructions are not followed, damage may occur during storage.

7.2 Setup

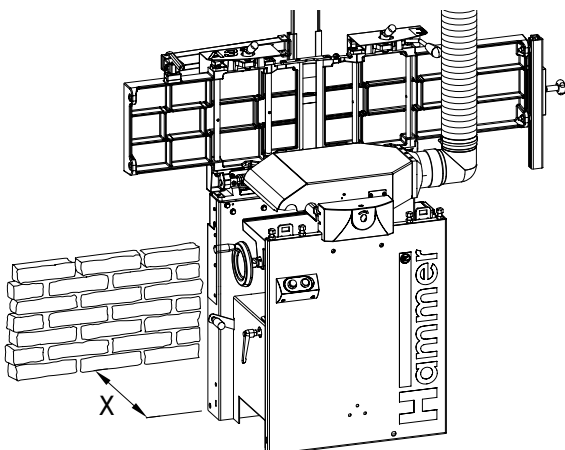

Installation site requirements:

- Operating/room temperature: +10° to +40° C
- Ensure that the work surface is sufficiently stable and has the proper load-bearing capacity
- Provide sufficient light at the workstation
- Ensure there is sufficient clearance for or from neighbouring workstations

In order to maintain and operate the machine properly, it must be set up at least 500 mm away from the wall, parallel to the work direction (measurement X) (Scale „X“)

Fig. 7-1: Space requirements

Setup and installation

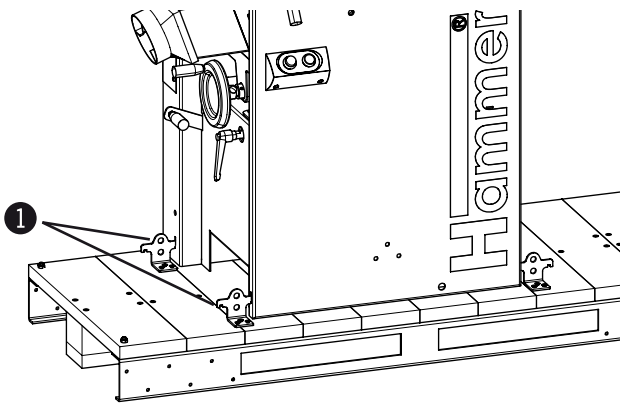

Fig. 7-2: Floor mounting

1. The machine will be transported to the installation location according to the specifications stated in the „Transport“ chapter and in the enclosed transport and assembly instructions
2. If necessary, the machine can be bolted down to the floor with the transport brackets.

1 Transport brackets

3. Remove the oxidation protective layer from all blank machine parts.

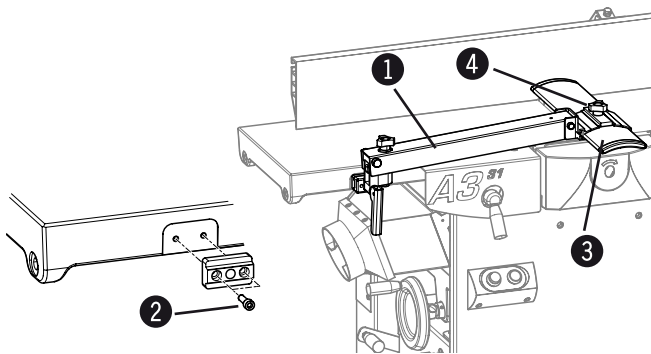

Fig. 7-3: Bridge guard

4. Assemble the guard rail and bridge guard:
 - Bridge guard arm: fasten with allen screws on the planer table.
 - Loosen the clamping screw.
 - Protective rail: thread into the arm of the bridge guard
 - Tighten the clamping screw.

1 Bridge guard arm

2 Allen screws

3 Protective rail

4 Clamping screw

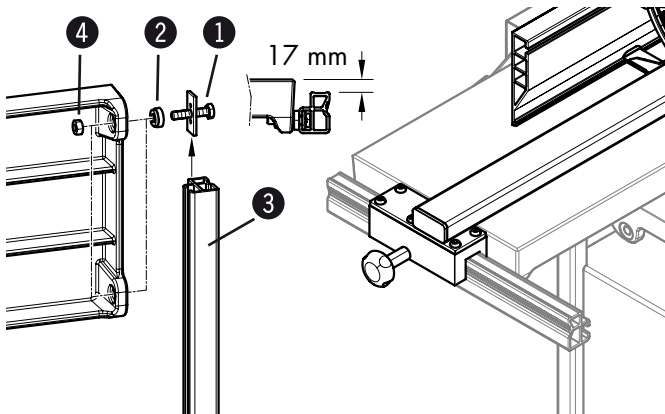

Fig. 7-4: Mount the planer fence

5. Mount the planer fence
 - Fasten guide rail to the machine table with screws, turn locks and spacing washers
 - Adjust the distance: 17 mm (This setting has to be exact.)
 - Tighten the nuts.

1 Screws

2 Spacer washers

3 Track

4 Nuts

7.3 Chip extraction



Attention!

The machine has to be connected to a dust extractor.

Vacuum hose must be flame-resistant and must conduct electricity! Be sure to use only genuine HAMMER vacuum hoses!

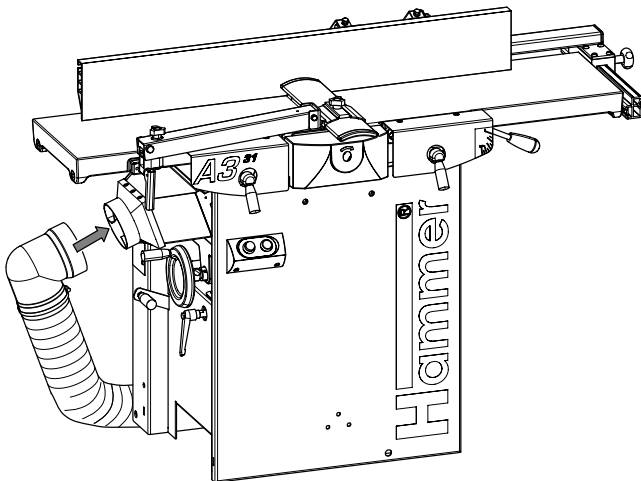

In order to hinder the build-up of dust, it is necessary to have a vacuum system with sufficient capacity. Before operating the machine for the first time, inspect it for defects.

Requirements for the dust extraction system and hoses:

- The extraction capacity has to generate the required low pressure and the required air speed (See technical data)
- Connect the dust extraction system to the machine in such a way so as to operate in unison with the machine.
- The dust extraction hoses must be electrically conductive and grounded to prevent electrostatic build up.

Fig. 7-5: Extractor port diameter

7.4 Electrical connection



Warning! Danger! Electric current:

Work on electrical fittings may only be carried out by qualified personnel and in strict observance of the safety instructions.



Note: It is prohibited to open the switch box on the machine without the express authorization from the HAMMER Service Department. Violating this stipulation shall render the right to make claims under the warranty null and void.

- The machine must be earthed with electrical conductors.
- The voltage fluctuations in the mains supply may not exceed $\pm 10\%$.
- The power supply cable must be protected against damage (e.g. armoured conduit)
- The power supply cable must be laid in such a way so it does not overbend or chafe and there is no risk of tripping over it.
- Safeguarding: triggering characteristic C
Three-phase current motor: 20 A,
Alternating-current motor: 16 A,
- Power supply cable at least
Three-phase current motor: 5x 2,5
Alternating-current motor: 3x 2,5



Warning! Danger! Electric current: Before hooking up the machine to the power supply, compare the specifications on the data plate with those of the electrical network. Only hook up the machine if the two sets of data correspond to each other. The electrical outlet must have the appropriate socket (for a three-phase alternating current motor, CEE).

7.4.1 Alternating-current motor

The machine's power cable is delivered with an open cable end, i.e. without a plug.

The operator is responsible for fitting the machine's power cable with a suitable plug in accordance with any country's specific regulations.

7.4.2 Three-phase alternating current motor

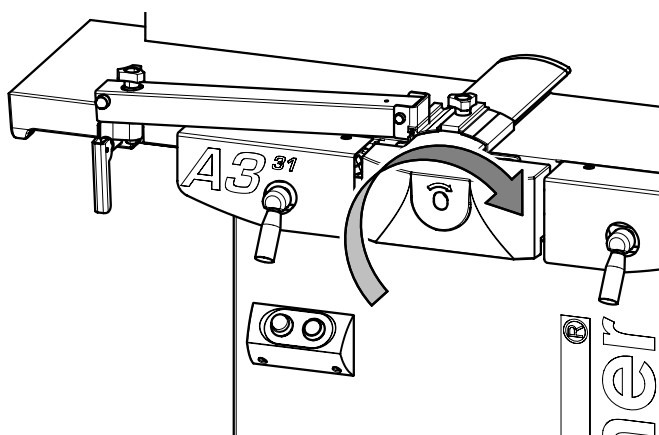

- Connect the plug to the power supply.
- Switch on and let the machine run briefly.
- While the motor is running, check its direction of rotation.
- Should a change in the direction of rotation be necessary, switch the two phases on the power cable.

Fig. 7-6: Direction of rotation

8 Making adjustments and preparations

8.1 Safety instructions



Warning! Risk of injury! Improper adjustment and setup work can lead to serious physical injury or material damage. For this reason, this work may only be carried out by authorised, trained personnel who are familiar with how to operate the machine and in strict observance of all safety instructions.

- Before beginning any maintenance work on the machine, switch it off and secure it against accidentally being switched on again.
- Before commencing any work with the machine, inspect it to ensure that it is complete and in technically good condition.
- Ensure that there is sufficient space to work around the machine.
- Keep the work area orderly and clean. Components and tools that are not put in their correct place or put away may be the cause of accidents!
- Install the safety equipment according to the instructions and check that it functions properly.



Warning! Danger! Electric current:
Work on electrical fittings may only be carried out by qualified personnel and in strict observance of the safety instructions.

8.2 Adjusting the depth of cut

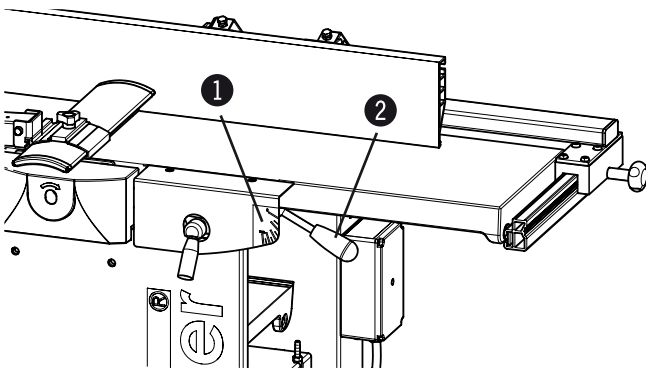

The depth of cut is adjusted with the adjustment wheel on the feeder-side of the planer table

Move the lever until the desired value has been achieved on the scale

- ① Scale
- ② Lever

Fig. 8-1: Adjusting the depth of cut



Note:

The maximum depth of cut is directly related to the following factors:

- Panel width Panel intensity
- Type of wood (hardwood or softwood)
- Wood dampness
- Feed rate
- Planer knives (SS, HS, HW)
- The motor power of your machine

Making adjustments and preparations

8.3 Adjusting the joint

The receiver-side of the planer table is set so that with a workpiece length of 2 m, an open joint of approximately 0.2 to 0.5 mm is produced (standard setting). The position of the outfeed side of the planer table must be adjusted with regards to the flight of the knife to achieve particular requirements (extremely splayed, open or straight joints):

- Planer table above circle of cut:
extremely open joint
- Planer table height at the circle of cut:
straight joint
- Planer table below circle of cut:
extremely splayed joint



Attention! Risk of injury!

The planer knives are razor sharp. Handle the planer knives with the utmost care, especially when turning the cutterblock by hand.

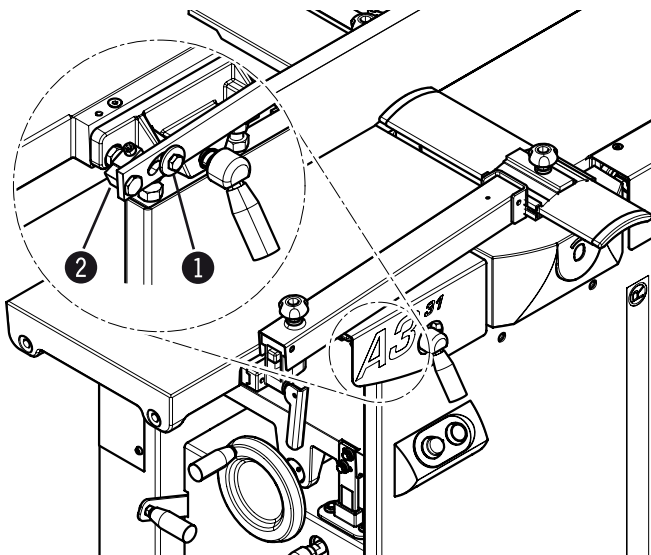

Fig. 8-2: Adjusting the joint

The joint adjustment is carried out on the receiver-side of the planer table:

Required tools:

Spanner 17 mm / 13 mm

1. Switch the machine off and ensure that it cannot be switched on again.
2. Loosen the clamping screw.
(Spanner 13 mm)
3. Eccentric: turn until the desired height of the planer table is reached
(Spanner 17 mm)
4. Tighten the clamping screw.
(Spanner 13 mm)
5. Check the adjustment with a gauge

- ① Clamping screw
- ② Eccentric

Checking the joint adjustment:

1. Prepare the gauge as shown in the illustration opposite.
2. Set the gauge on the receiver-side of the planer table edge to "0".
3. Turn the cutterblock manually.
4. The planing knives should move the gauge 2 to 3 mm. (usual setting)

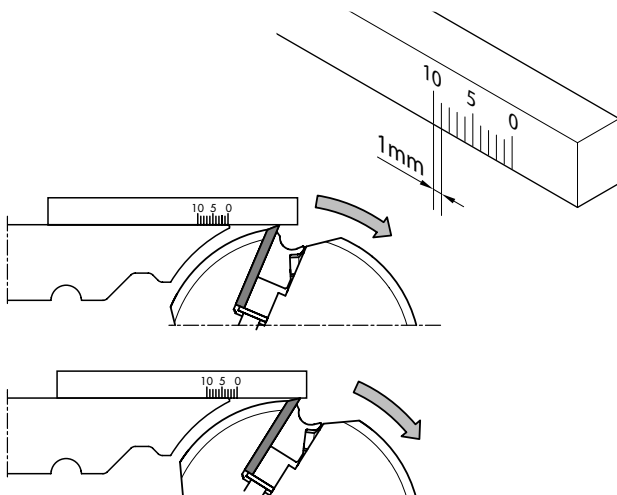
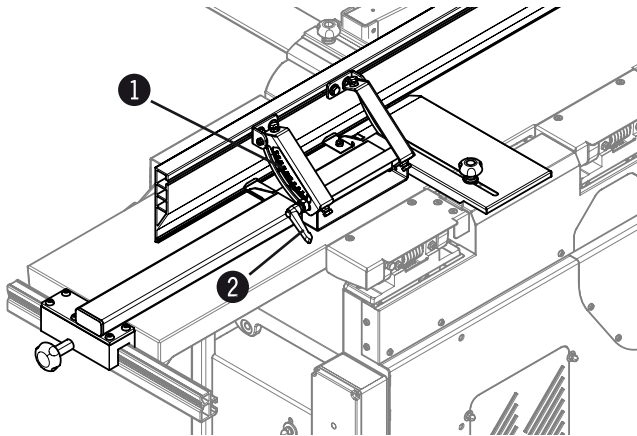

Fig. 8-3: Checking the joint adjustment

8.4 Adjusting the planer fence

8.4.1 Adjusting the angle



1. Switch off the machine
2. Loosen the clamping lever.
3. Set the angle between 90° and 45° on the scale.
4. Clamp the clamping lever.

- ① Scale
- ② Clamping lever

Fig. 8-4: Adjusting the planer fence

8.4.2 Sliding

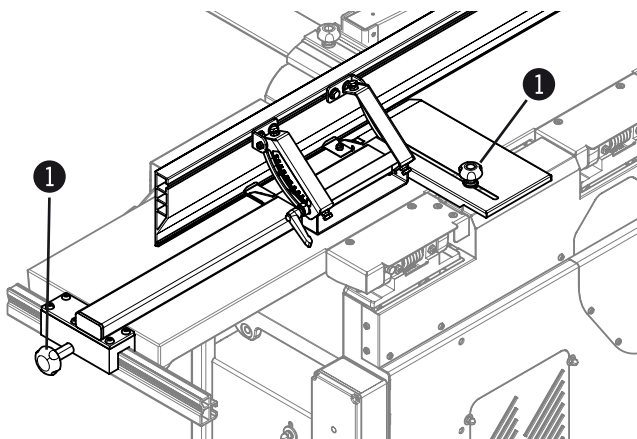

Adjusting the settings to the width of the workpiece:

1. Switch off the machine
2. Loosen the thumb screws.
3. Move the combination fence into the desired position.
4. Tighten the thumb screws.

- ① Thumb screws

Fig. 8-5: Move the planer fence

Making adjustments and preparations

8.5 Adjust the thickening height

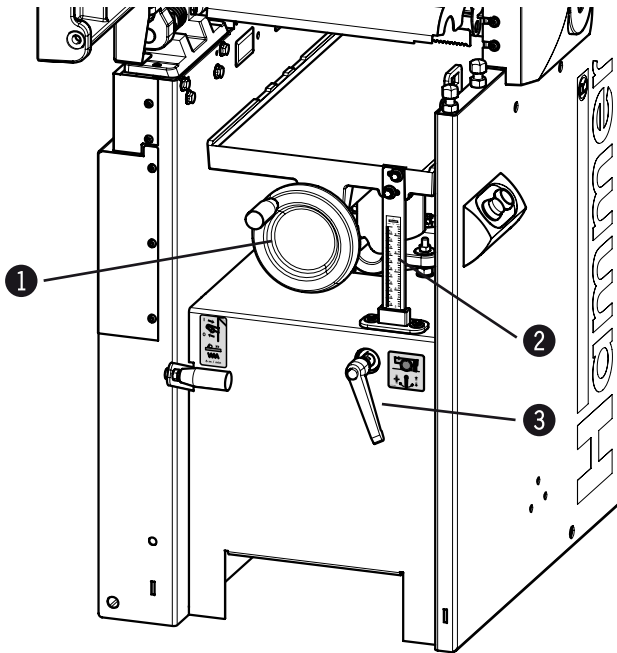

The cutting depth is adjusted by means of the thickening table:

1. Switch off the machine
2. Measure the thickness of the workpiece.
3. Loosen the clamping lever.
4. Use the system handwheel to set the desired measurement: thickness of the workpiece minus cutting depth
5. Clamp the clamping lever.

- ① System handwheel
- ② Scale
- ③ Clamping lever

Fig. 8-6: Adjust the thickening height



Note:

To compensate for the thread clearance, adjust the thickening table from bottom to top.
Use the digital display (accessory) to adjust the thickening height exactly.
(See assembly instructions „Digital clock“).



Note:

The maximum chip thickness per work cycle is 4 mm.

When smooth planing, the maximum cutting depth is 1 mm.

The maximum depth of cut is directly related to the following factors:

- Panel width Panel intensity
- Type of wood (hardwood or softwood)
- Wood dampness
- Feed rate
- Planer knives (SS, HS, HW)
- The motor power of your machine

8.6 Adjusting the drilling support

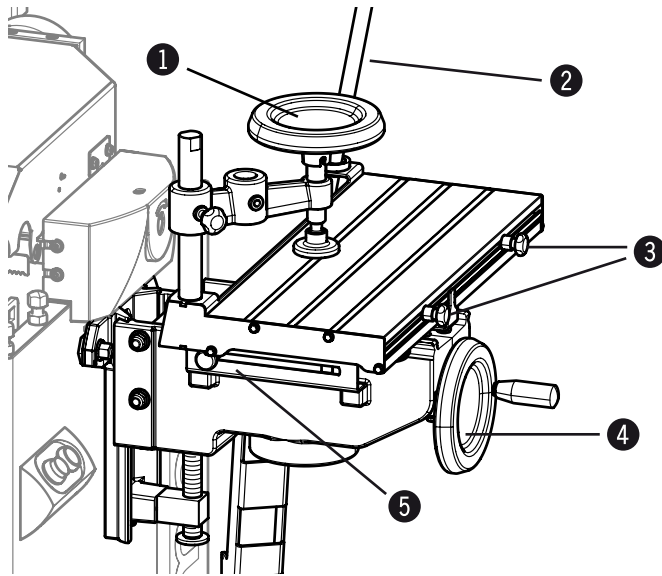

Fig. 8-7: Adjusting the drilling support

- **Height adjustment** – Infinitely variable with system handwheel
- **Longitudinal adjustment** – With the one-hand lever
- **Depth adjustment** – With the one-hand lever
- **Mortising depth limit stop** – With depth stop
- **Mortising length limit stop** – With the two lateral stops
- **Stabilising the workpiece on the table** – With the rotating clamp

- ① Rotating clamp
- ② Single-hand lever
- ③ Longitudinal stops
- ④ System handwheel
- ⑤ Depth stop



Note: Use the digital display (accessory) to adjust the drilling height precisely (See assembly instructions „Digital clock“).

Making adjustments and preparations

8.7 Retooling from a planer to a thicknesser

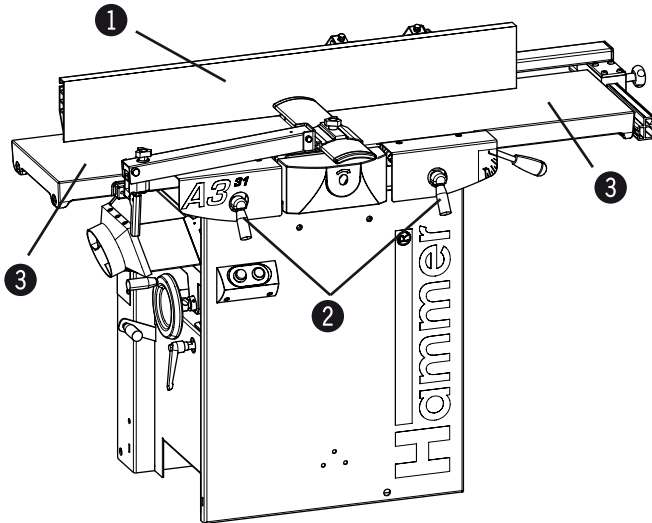

Fig. 8-8: Open planer table

1. Before beginning any maintenance work on the machine, switch it off and secure it against accidentally being switched on again.
2. Push the planer fence right to the front.
See Chapter >8.4 Adjusting the planer fence<
3. Loosen and pull out the clamping lever.
4. Open the planer table and ensure that the fall lock engages correctly.

- ① Planer fence
- ② Clamping lever
- ③ Planer tables
- ④ Safety catch

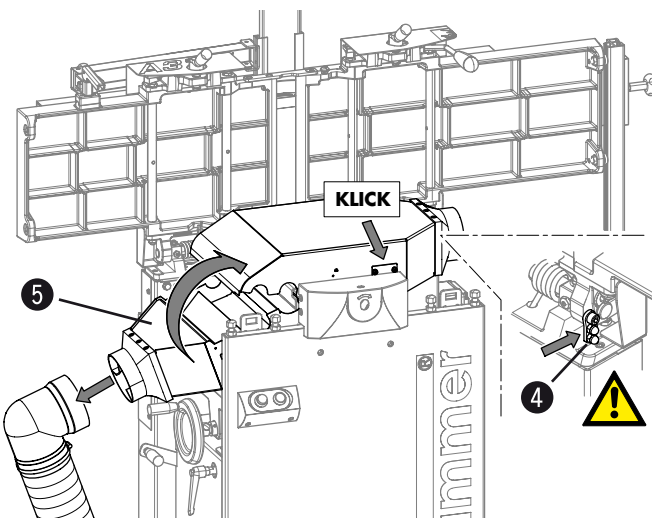

Fig. 8-9: Tilt up the vacuum hood

5. Remove the vacuum hose from the vacuum hood
6. Tilt up the vacuum hood
Ensure the extraction hood slots into place correctly
7. Attach the vacuum hood by means of the connector to a suitable vacuum system.
See Chapter >7.3 Chip extraction<

- ⑤ Vacuum hood



Note:

Safety break switches are breaking the electric circuit.

The planer arbor can only run when the joiner tables are closed or the extractor hood is tilted up.

8.8 Retooling from a thicknesser to a planer

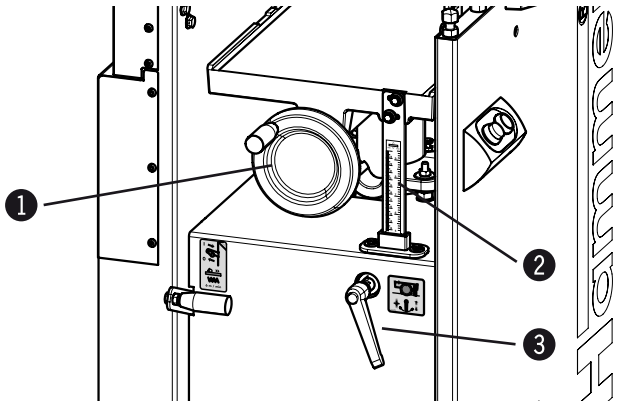

Fig. 8-10: Thicknesser table

1. Before beginning any maintenance work on the machine, switch it off and secure it against accidentally being switched on again.
2. Loosen the clamping lever.
3. Using the system handwheel, position the thicknessing table at least 200 mm below the cutterblock.
4. Clamp the clamping lever.

- ① System handwheel
- ② Scale
- ③ Clamping lever

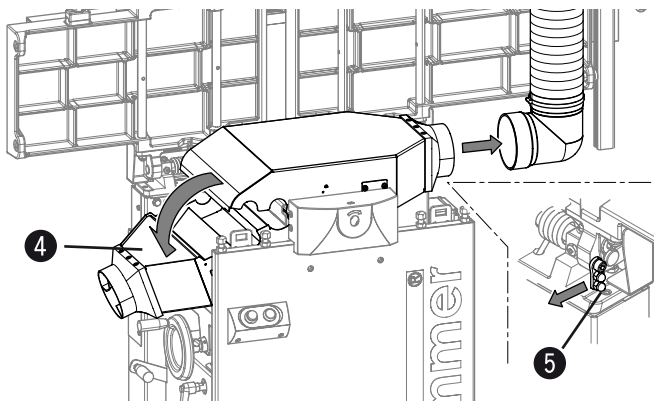

Fig. 8-11: Tilt the vacuum hood downwards

5. Remove the vacuum hose from the vacuum hood
6. Tilt the vacuum hood downwards
7. Release fall lock/tilt the planer table to you.

- ④ Vacuum hood
- ⑤ Safety catch

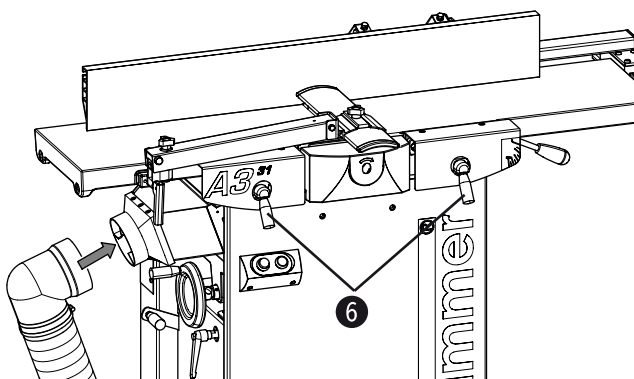

Fig. 8-12: Planer tables

8. Press the clamping lever inwards and lock in place.
7. Attach the vacuum hood by means of the connector to a suitable vacuum system.
See Chapter >7.3 Chip extraction<

- ⑥ Clamping lever



Note:
Safety break switches are breaking the electric circuit.
The planer arbor can only run when the joiner tables are closed or the extractor hood is tilted up.

Making adjustments and preparations

8.9 Retooling to the drilling unit

8.9.1 Mounting the mortising support

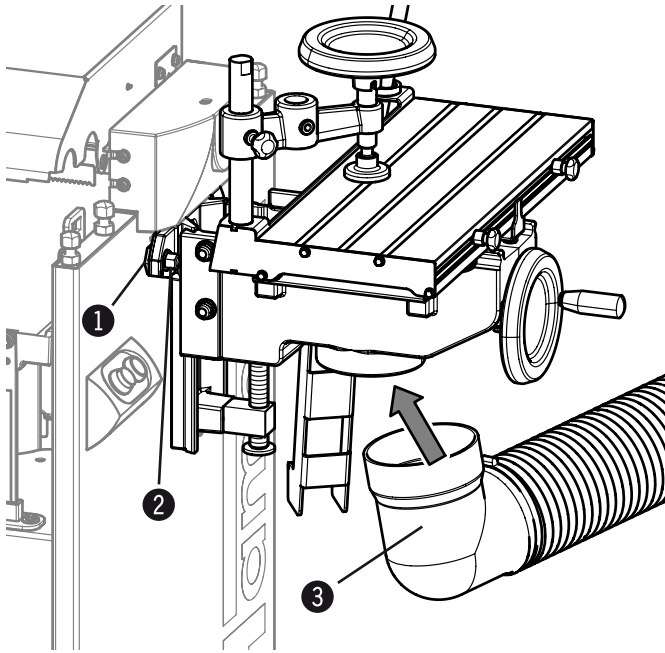

Fig. 8-13: Mounting the mortising support

1. Prior to starting to work with the machine, switch it off and secure it against being switched on again.
2. If necessary, mount the coupler unit (accessory). If necessary, mount the 2-jaw drilling chuck (accessory). (See assembly instructions „Drilling chuck and coupler unit“)
3. Both planer tables must be tilted up and secured with the fall locks (Position „Thickness planing“)
4. Affix the drilling table:
 - Depth adjustment in the hindmost position and
 - Adjust the length in the middle position
5. Hook the mortising table into the seating bolt
6. Attach the drilling support with the nuts.
7. Connect the drilling support by means of the extractor port to a suitable extraction system
See Chapter >7.3 Chip extraction<

- ① Seating bolt
- ② Nuts
- ③ Vacuum connector

8.9.2 Clamp the drilling tool

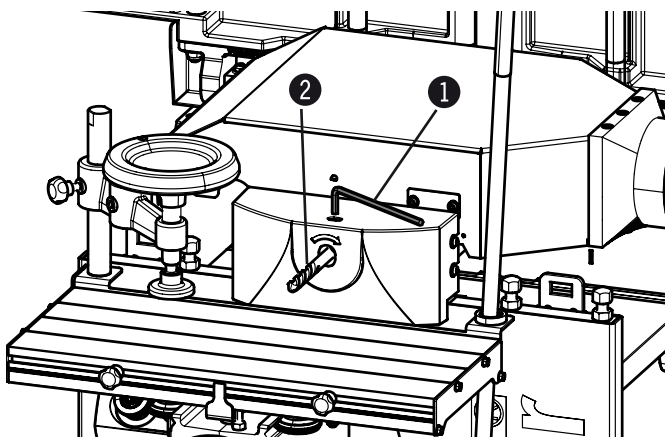

Fig. 8-14: Clamp the drilling tool

1. Prior to starting to work with the machine, switch it off and secure it against being switched on again.
2. Open the 2-jaw chuck with an 8 mm Allen key.
3. Clamp the authorised drilling tool along the entire length of the chuck
See Chapter >9.6 Drilling<
4. Clamp the 2-jaw chuck with an 8 mm Allen key (minimum torque 20 Nm).

- ① Allen key 8 mm
- ② Drilling tool

8.10 Retooling from a drilling operation to a planer or a thicknesser operation

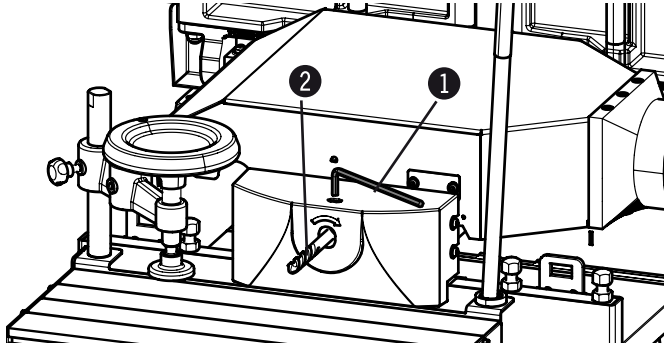

Fig. 8-15: Unchuck the drilling tool

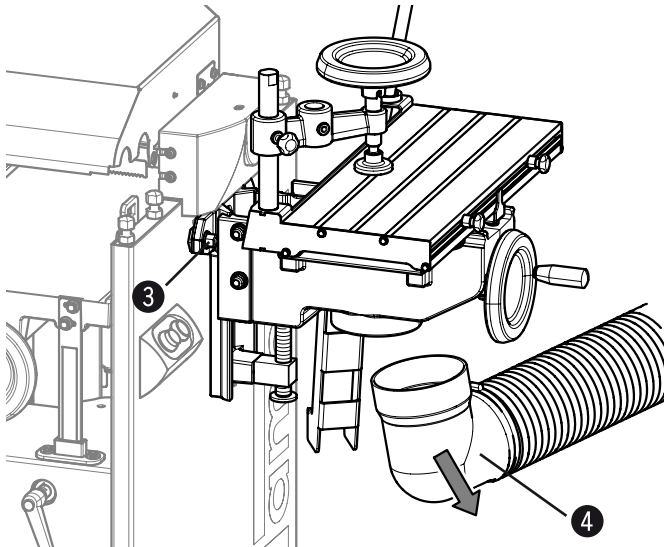

Fig. 8-16: Removing the drilling support

1. Prior to starting to work with the machine, switch it off and secure it against being switched on again.
2. Unchuck the drilling tool:
 - Open the 2-jaw chuck with an 8 mm Allen key
 - Remove the drilling tool from the drilling chuck

- ① Drilling tool
- ② Allen key

3. Removing the drilling support:
 - Release the extractor hose from the extraction port
 - Affix the drilling table:
 - Depth adjustment in the hindmost position and
 - Adjust the length in the middle position
 - Loosen the nuts.
 - Detach the drilling table
4. If required, change the tooling to surface planing or thickness planing.

- ③ Nuts
- ④ Vacuum connector

9 Operation

9.1 Safety instructions



Warning! Risk of injury! Improper operation may lead to severe physical injury or material damage. For this reason, this work may only be carried out by authorised, trained personnel who are familiar with how to operate the machine and in strict observance of all safety instructions.

Before starting work:

- Before commencing any work with the machine, inspect it to ensure that it is complete and in technically good condition.
- Ensure that there is sufficient space to work around the machine.
- Keep the work area orderly and clean. Components and tools that are not put in their correct place or put away may be the cause of accidents!
- Properly adjust both planer tables.
- Adjust the combination fence to the workpiece width and lock.
- Install the bridge guard and rear cutterblock cover as directed and test their function.
- Ensure that all the planer knives are sharp (minimises the kickback risk)
- Ensure that all clamping screws on the knife holders are securely tightened (minimum tightening torque 15 Nm)
- Ensure that the individual kickback guards are free to move and that they fall back into their initial position after having been raised.
- Install the dust extraction system according to the instructions and test its function.
- Only machine workpieces that can be safely placed on the machine and guided.
- Carefully inspect workpieces for foreign matter (nails, screws) which might impair processing.
- When planing, additionally support workpieces that are longer than the feeder- and receiver-sides (by using e.g. table extensions, roller supports)
- Ensure that the tool turns freely.
- Ensure the cutterblock direction of rotation is correct
- Keep tools for handling short and narrow workpieces close at hand (e.g.: wooden pushing stick, push block; See HAMMER-Accessory catalogue)
- Before switching on the machine, always check to make sure that there are no other persons in the immediate vicinity of the machine

When working on or with the machine, the following must always be worn by personnel:

- Sturdy, tight-fitting clothing (tear-resistant, no wide sleeves).
- Protective footwear – that protect the feet from heavy falling objects and prevent sliding on slippery floors
- Hearing protection – To protect against loss of hearing

During operation:

- Never place your hands on the workpiece over the cutterblock.
- When changing to another workpiece or if a malfunction occurs, first switch off the machine and then secure it against being switched on again accidentally
- Do not switch off, circumvent or decommission protective and safety devices during operation

When working on or with the machine, the following must be strictly observed:

- Persons with long hair who are not wearing a hairnet are not permitted to work on or with the machine!
- It is prohibited to wear gloves while working on or with the machine!

9.2 Switching on the machine



Note: It is only permitted to switch on the machine if, for the work at hand, the required preconditions are fulfilled and any preliminary work is completed. Therefore, the adjusting, fitting and operating instructions (see the corresponding chapters) must be read before switching on the machine.

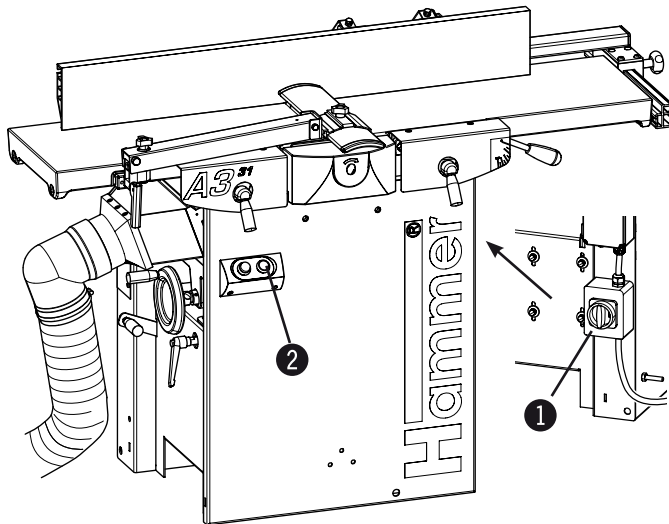

1. Connect the machine to the main power supply.
 2. If available: unlock the main switch and switch on (position "I").
 3. **Only with alternating current:**
 - Press the green button on the control panel and hold it pressed down.
 - Release the push button once the machine has reached the maximum rotational speed.
- With a three-phase current motor**
- Press green push button on the control panel and release.

- ① Main switch
② Green push button - ON

Fig. 9-1: Switching on the machine



Attention! Risk of material damage!
Improper operation may cause damage to the machine.
Do not activate the green push button whilst the machine is in operation!

9.3 Switching off the machine / EMERGENCY-STOP

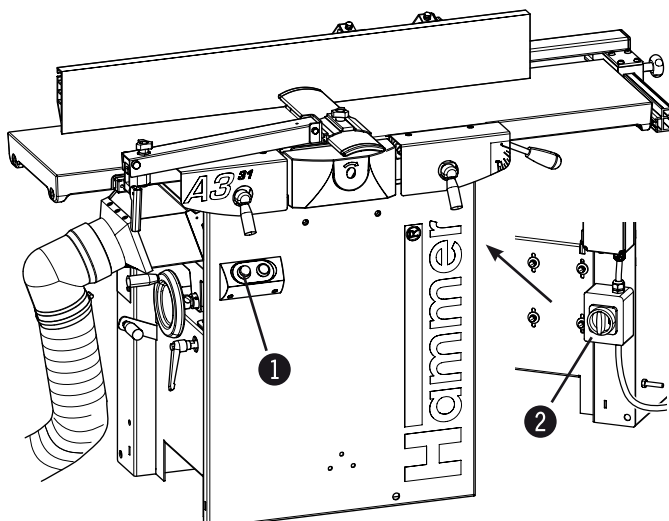

1. Push and release the red push button.
The machine is stopped automatically.
2. If available: switch off the main switch (position "0") and secure.
3. Disconnect the machine from the main power supply.

- ① Red push button - OFF
② Main switch

Fig. 9-2: Switching off the machine

Operation

9.4 Surface planing



Note: Surface planing evens irregular workpiece surfaces.
The workpieces are guided over the cutterblock and only their undersides are machined.
The direction of cutterblock rotation is opposite to the feed direction of the workpiece.

9.4.1 Working position

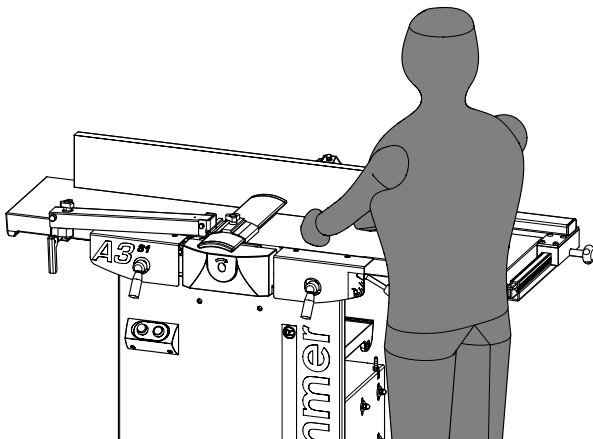

Take up the position as shown in the opposite picture when working with the machine

Fig. 9-3: Work place/work position

9.4.2 Workpiece dimensions

Length	under 250 mm:	only work with special devices (e.g.: wooden pushing stick)
	over 1500 mm:	only work with table extensions or with a second person
Width	max. 260 mm / 310 mm / 410 mm (depending on the equipment)	
Thickness	min. 10 mm	



Attention! Risk of injury!

If a workpiece is smaller than 10 mm, it may split if the depth of cut is too large (4 mm).
The finished planed workpiece must not be thinner than 6 mm!

9.4.3 Authorised and prohibited work techniques

Only the following working techniques are permitted with the planer unit:

- Planing the wide side of a workpiece
- Jointing the narrow side of a workpiece
- Bevelling the narrow side of a workpiece
- Bevelling the edges of a workpiece

The following working techniques are absolutely forbidden with the planer unit:

- Down-cut planing (direction of cutterblock rotation is the same as feed direction)
- Insertion cuts (the workpiece is not worked over its entire length)
- Planing workpieces that are very warped
- Rabbet planing at the end of the cutterblock

9.4.4 Surface planing - Workpieces up to 75 mm thick

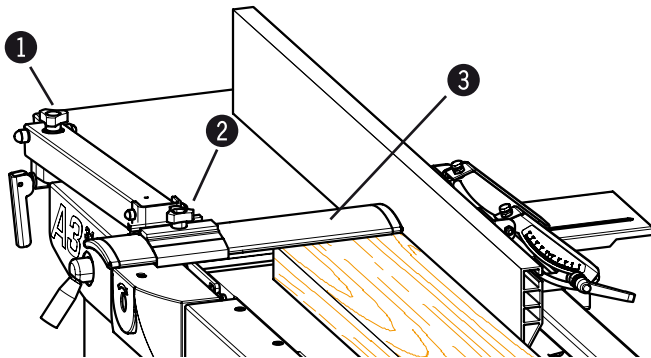

Fig. 9-4: Bridge guard

- ① Setscrew
- ② Clamping screw
- ③ Protective rail

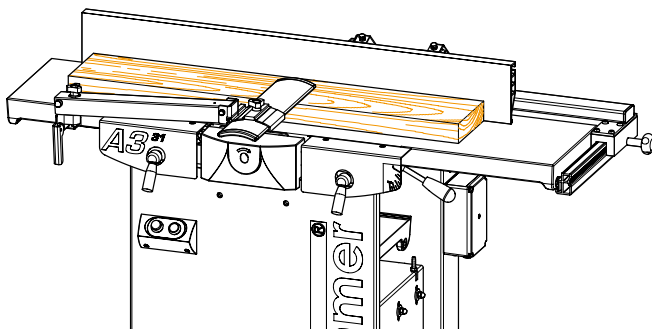

Fig. 9-5: Guiding the workpiece

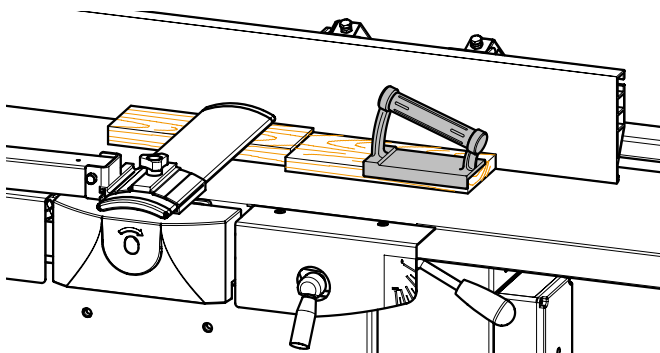

Fig. 9-6: Wooden push stick and push block

1. Before beginning any maintenance work on the machine, switch it off and secure it against accidentally being switched on again.
2. Both planer tables must be shut and fixed with the clamping levers.
3. Set the gear lever to the "0" setting.
4. Extraction system must be connected
5. Planer fence: set at 90°.
6. Adjusting the depth of cut.
7. Adjust the joint, if necessary.

8. Adjust the bridge guard:

- Use the setscrew to fix the guard rail approx. 2 mm over the workpiece.
- Place the workpiece against the planer fence and push it slightly under the guard rail (not over the cutterblock!).
- Loosen the clamping screw.
- Move the guard rail right up to the planer fence.
- Tighten the clamping screw.

9. Switch the machine on

10. Take up work position.

11. Machining the workpiece:

- Lay your hands flat on the workpiece, ensuring that your fingers are balled into a fist and thumbs are pressed against the workpiece.
- Push the workpiece straight over the feeder-side of the planer table.
- Then let your hands glide one after the other over the bridge guard.
- As soon as it is possible, use both hands to continuously push the workpiece on the receiver-side of the planer table.
- The pushing stick must not be thicker than the workpiece after it is cut.

12. If you are not going to continue working, switch off the machine and secure it against being turned on again accidentally



Attention! Risk of injury!
When planing smaller workpieces, use a pushing stick or pushing block.

Operation

9.4.5 Surface planing - Workpieces over 75 mm thick

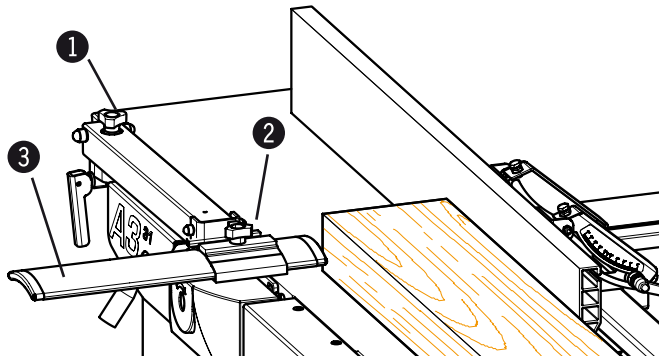

Fig. 9-7: Bridge guard

- ① Setscrew
- ② Clamping screw
- ③ Protective rail

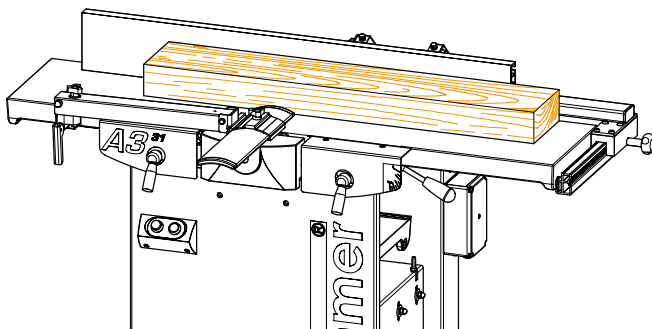

Fig. 9-8: Guiding the workpiece

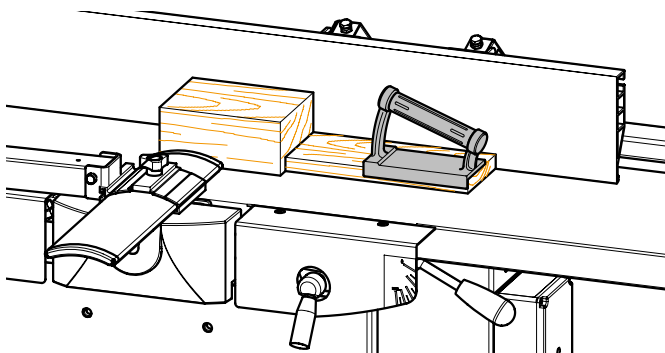

Fig. 9-9: Wooden push stick and push block

1. Before beginning any maintenance work on the machine, switch it off and secure it against accidentally being switched on again.
2. Both planer tables must be shut and fixed with the clamping levers.
3. Set the gear lever to the "0" setting.
4. Extraction system must be connected
5. Planer fence: set at 90°.
6. Adjusting the depth of cut.
7. Adjust the joint, if necessary.
8. **Adjust the bridge guard**
 - Loosen the clamping screw.
 - Pull out the guard rail (slightly more than the workpiece width).
 - Place the workpiece against the planer fence and push it to the front edge of the feeder planer table (not over the cutterblock!).
 - Bring the guard rail right up to the workpiece
 - Tighten the clamping screw.
 - Use the setscrew to lower the guard rail to the planer table.
9. Switch the machine on
10. Take up work position.
11. **Machining the workpiece:**
 - Lay your hands flat on the workpiece, ensuring that your fingers are balled into a fist and thumbs are pressed against the workpiece.
 - Guide the workpiece straight along the fence over the feeder-side of the planer table.
 - As soon as it is possible, use both hands to continuously push the workpiece on the receiver-side of the planer table.
 - The pushing stick should not be thicker than the workpiece.
12. If you are not going to continue working, switch off the machine and secure it against being turned on again accidentally



Attention! Risk of injury!
When planing smaller workpieces, use a pushing stick or pushing block.

9.4.6 Jointing



Note: To obtain exact joints, use only evenly grown wood without any knots.

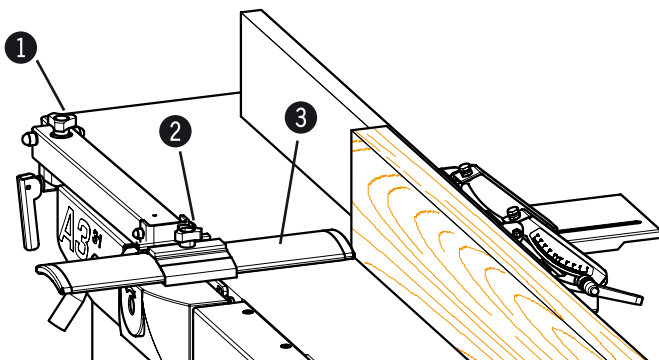

Fig. 9-10: Bridge guard

- ① Setscrew
- ② Clamping screw
- ③ Protective rail

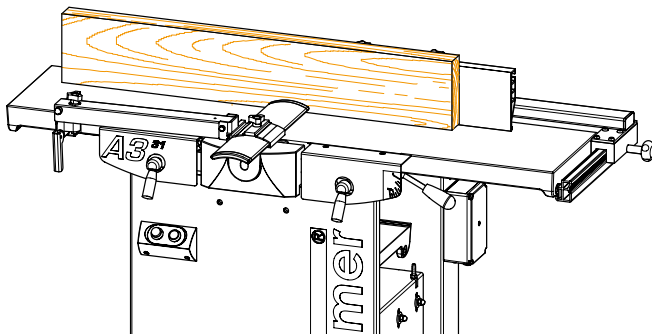

Fig. 9-11: Guiding a workpiece

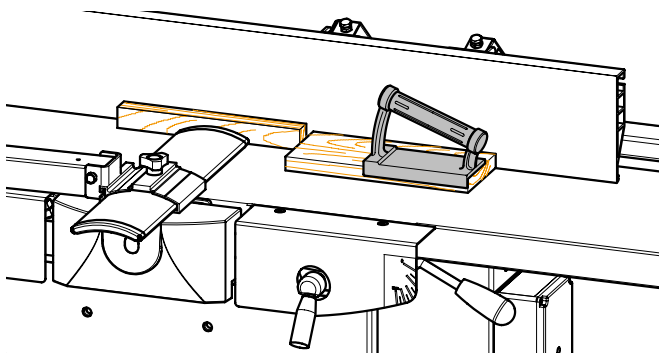

Fig. 9-12: Wooden push stick and push block

1. Before beginning any maintenance work on the machine, switch it off and secure it against accidentally being switched on again.
2. Both planer tables must be shut and fixed with the clamping levers.
3. Set the gear lever to the "0" setting.
4. Extraction system must be connected
5. Planer fence: set at 90°.
6. Adjusting the depth of cut.
7. Adjust the joint, if necessary.
8. **Adjust the bridge guard**
 - Loosen the clamping screw.
 - Pull out the guard rail. (somewhat more than the width of the workpiece).
 - Place the workpiece against the planer fence and push it to the front edge of the feeder planer table (not over the cutterblock).
 - Bring the guard rail right up to the workpiece
 - Tighten the clamping screw.
 - Use the setscrew to lower the guard rail to the planer table.
9. Switch the machine on
10. Take up work position.
11. **Machining the workpiece:**
 - With your left hand (balled into a fist and the thumbs placed onto the workpiece), press the workpiece against the combination fence and the receiver-side of the planer table.
 - With your right hand (balled into a fist and the thumbs placed onto the workpiece), push the workpiece smoothly over the cutterblock
 - The pushing stick should not be thicker than the workpiece.
12. If you are not going to continue working, switch off the machine and secure it against being turned on again accidentally



Attention! Risk of injury!
When jointing smaller workpieces, use a pushing stick or pushing block.

Operation

9.4.7 Bevelling/Chamfering



Note: With this procedure, the edges of a workpiece can be bevelled or tapered to any desired angle (max. -45°).

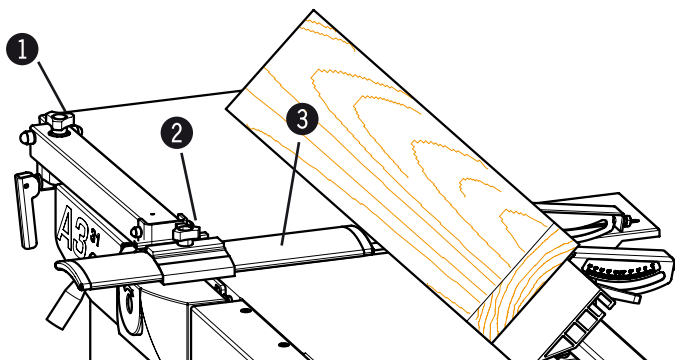

Fig. 9-13: Bridge guard

- ① Setscrew
- ② Clamping screw
- ③ Protective rail

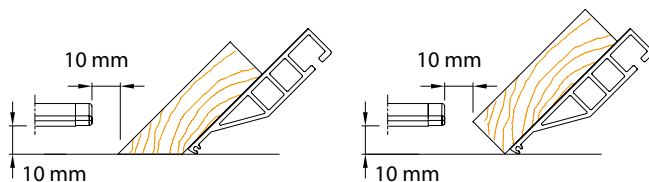

Fig. 9-14: Bridge guard

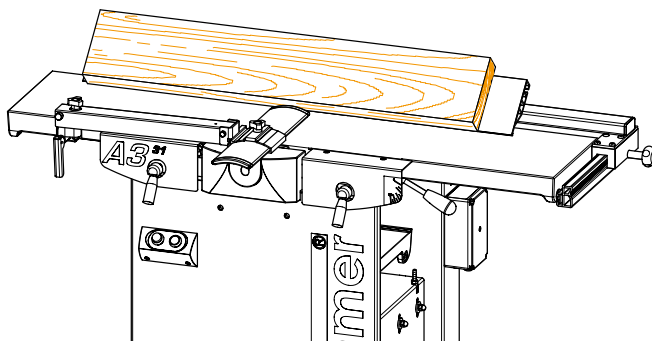
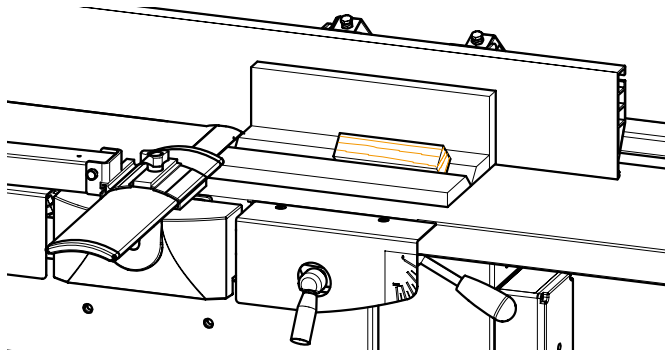

Fig. 9-15: Guiding a workpiece

1. Before beginning any maintenance work on the machine, switch it off and secure it against accidentally being switched on again.
2. Both planer tables must be shut and fixed with the clamping levers.
3. Set the gear lever to the "0" setting.
4. Extraction system must be connected
5. Planer fence: Adjusting the angle
6. Adjusting the depth of cut.
7. Adjust the joint, if necessary.
8. **Adjust the bridge guard:**
 - Loosen the clamping screw.
 - Pull out the guard rail. (somewhat more than the width of the workpiece).
 - Place the workpiece against the planer fence and push it to the front edge of the feeder planer table (not over the cutterblock).
 - Bring the guard rail up to 10 mm of the workpiece.
 - Tighten the clamping screw.
 - Use the setscrew to fix the guard rail 10 mm over the planer tables.
9. Switch the machine on
10. Take up work position.
11. **Machining the workpiece:**
 - To avoid the workpiece sliding down the inclined surface, using the left hand, press the workpiece mainly against the planer fence and only slightly against the feeder side of the planer table.
 - With your right hand (balled into a fist and the thumbs placed onto the workpiece), push the workpiece smoothly over the cutterblock
12. If you are not going to continue working, switch off the machine and secure it against being turned on again accidentally

9.4.8 Tapering/beveling small workpieces



See Chapter:
>9.4.7 Bevelling/Tapering<

- When bevelling or tapering small, narrow workpieces, always use a special power feeder.
- The power feeder is mounted onto the planer fence.
- Set the bridge guard all the way down and let the protective bridge rest against the power feeder.

Fig. 9-16: Jig



Attention! Risk of injury!
When bevelling or tapering small, narrow workpieces, always use a special power feeder.

9.5 Thickness planing



Note: Workpieces that already have a planed surface can be made thinner by being thicknessed. The workpieces are guided through the planer. The workpiece lies with its planed surface on the thicknessing table, and only the upper side is machined.

9.5.1 Workpiece dimensions

Width	max. 206 mm / 306 mm / 406 mm (depending on the equipment)
Thickness	min. 4 mm max. 250 mm

9.5.2 Authorised and prohibited work techniques

Only the following working technique is permitted on the thicknessing unit:

- A maximum of 2 workpieces can be thickness-planed simultaneously.

It is absolutely forbidden to perform the following working technique on the thicknessing unit:

- Thicknessing several workpieces of varying thicknesses



Attention! Risk of material damage!
When working on 2 workpieces simultaneously, their thickness may not differ by more than 1 mm.

Operation

9.5.3 Work place/work position

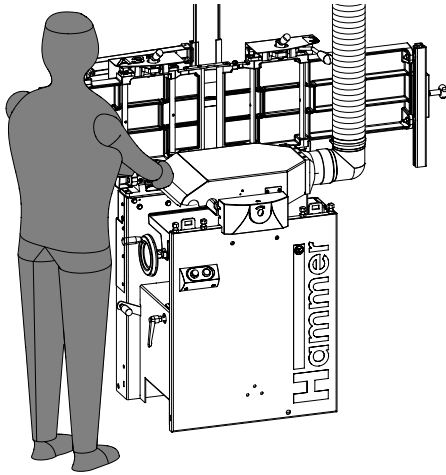

Fig. 9-17: Working position

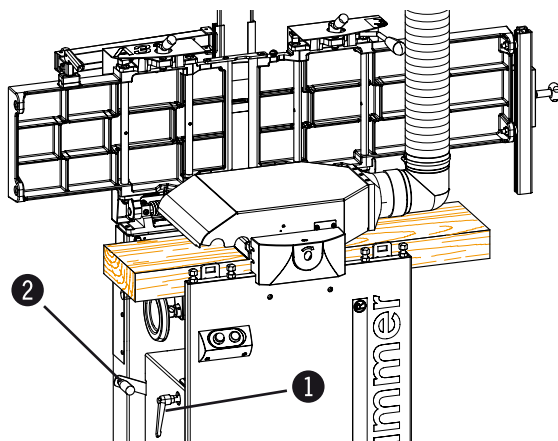

Fig. 9-18: Working a single workpiece

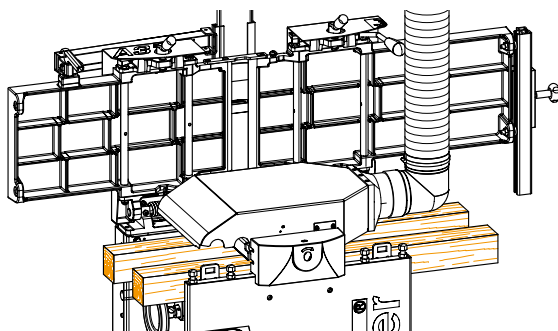

Fig. 9-19: Working two workpieces

When working, adopt the working position displayed in the diagram opposite.

1. Before beginning any maintenance work on the machine, switch it off and secure it against accidentally being switched on again.
2. If required, retool from surface planing to thickness planing.
3. Extraction system must be connected
4. Every time the machine is put into operation, test the kickback guards to ensure that they are functioning properly.
5. Adjust the thickening height.
Use the system handwheel to set the desired measurement.
Clamp the clamping lever.
6. Switch the machine on
7. Lift and then release the gear lever
8. Take up work position.
9. **Machining the workpiece:**
 - Push the workpiece into the machine until it is pulled in by the feed rollers.
 - When the workpiece exits on the other side, support it so it does not tip down
10. If you are not going to continue working, switch off the machine and secure it against being turned on again accidentally
11. Set the gear lever to the "0" setting.

- ① Clamping lever
- ② Gear lever



Note: For easy handling, use the table extensions (See assembly instructions „Table extension“).



Note: A maximum of 2 workpieces may be worked simultaneously. The thickness of the workpieces may not differ by more than 1 mm. The workpieces must each be inserted at the end of the feed roller.

9.6 Drilling



Note: A workpiece lying on the mortising table is held in place by an eccentric clamp and can only be machined on the front side.



Attention! Risk of injury!

The drill bit can bore all the way through the workpiece. Do not place your hand on the workpiece in the vicinity of the bore.

9.6.1 Work place/work position

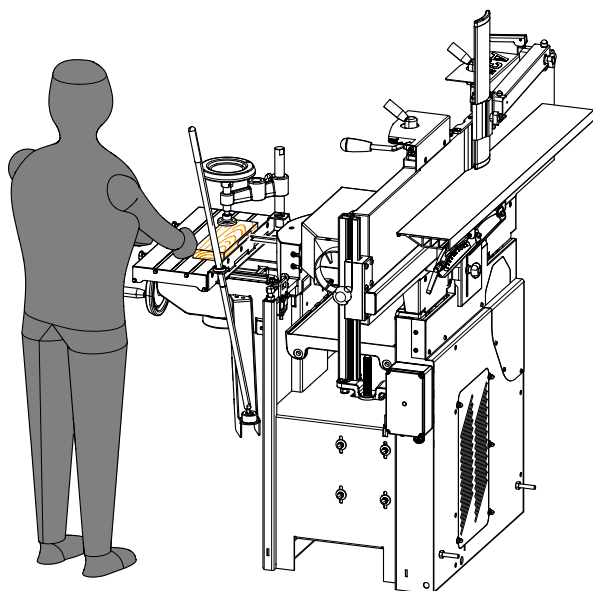

Fig. 9-20: Work place/work position

When working, adopt the working position displayed in the diagram opposite.

Use only original HAMMER mortising tools (See Accessory catalogue) Only the following left-hand cutting tools are authorised:

Dowel bit	Ø 4–6 mm
Router bit	Ø 4–16 mm
Forstner drill	Ø 15–35 mm
Plug cutters	Ø 10–35 mm

9.6.2 Workpiece dimensions

Length	max. 1500 mm
Width	max. 200 mm
Thickness	max. 100 mm

9.6.3 Authorised and prohibited work techniques

Only the following working techniques are permitted on the drilling unit:

- Drilling holes with or without a depth stop
- Removing knots
- Creating dowel holes
- Producing slots and deep holes

It is absolutely forbidden to perform the following working techniques on the drilling unit:

- Using abrasive wheels of any kind
- Moulding with moulding tools

9.6.4 Drilling with/without a depth fence

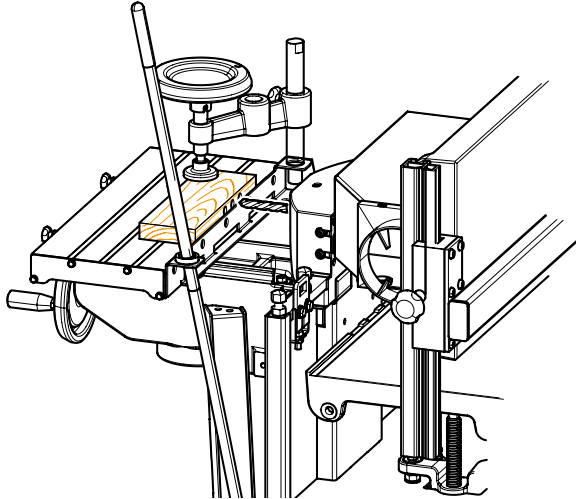

Fig. 9-21: Drilling a hole

1. Before beginning any maintenance work on the machine, switch it off and secure it against accidentally being switched on again.
2. Retooling to a drilling operation.
3. Set the gear lever to the "0" setting.
4. Extraction system must be connected
5. Clamp the drilling tool.
6. Lay the workpiece against the workpiece stop edge and clamp.
7. Set the desired drilling depth with the depth stop if required.
8. Switch the machine on
9. Take up work position.
10. In addition, support the workpiece with your left hand and drill a hole.
11. If you are not going to continue working, switch off the machine and secure it against being turned on again accidentally

9.6.5 Mortising

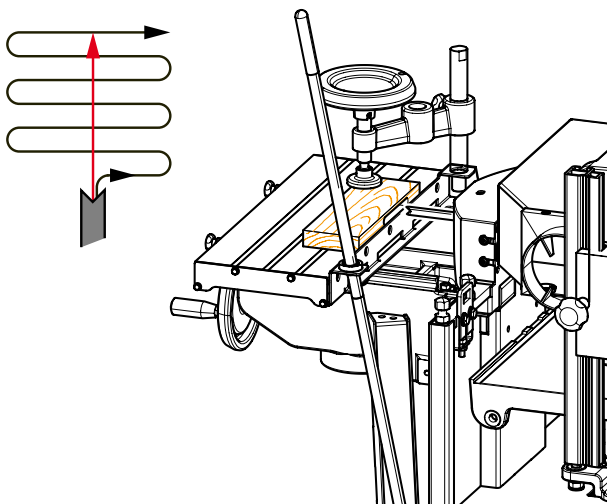

Fig. 9-22: Mortising

1. Before beginning any maintenance work on the machine, switch it off and secure it against accidentally being switched on again.
2. Retooling to a drilling operation.
3. Set the gear lever to the "0" setting.
4. Extraction system must be connected
5. Clamp the drilling tool.
6. Lay the workpiece against the workpiece stop edge and clamp.
7. Set the desired mortise limit with the longitudinal stops.
8. Switch the machine on
9. Take up work position.
10. In addition, hold the workpiece with the left hand.
 - Using the mortising tool, dip a few millimeters into the workpiece and trace the limited path.
 - After that, insert the mortise several millimetres into the workpiece and drive it through the limited path.
 - Repeat this process until the depth of the mortise is achieved.
11. If you are not going to continue working, switch off the machine and secure it against being turned on again accidentally

10 Service

10.1 Safety instructions



Warning! Risk of injury! Improper maintenance can cause serious injury or damage. For this reason, this work may only be carried out by authorised, trained personnel who are familiar with how to operate the machine and in strict observance of all safety instructions.

- Before beginning any maintenance work on the machine, switch it off and secure it against accidentally being switched on again.
- Keep the work area orderly and clean. Components and tools that are not put in their correct place or put away may be the cause of accidents!
- Ensure that there is sufficient space to work around the machine.
- Following the maintenance work, reinstall the guards and check that they are functioning properly.



Warning! Danger! Electric current:
Work on electrical fittings may only be carried out by qualified personnel and in strict observance of the safety instructions.

10.2 Maintenance schedule

Interval	Component	Task to accomplish
Daily	Machine	Remove dust and shavings
	Table surfaces	Remove dust and shavings
	Planer fence	Remove dust and shavings
	Dust extractor	Check for defects
	Kickback guards	Check if functioning, if necessary remove any resin residue
Monthly OR: approx. Every 40 operating hours	Dust extractor	Check efficiency
	Drive belt	Check, if necessary: readjust the tension or replace
	Feed rollers	Remove any resin residue
	Height spindle (Thicknesser table)	Control and lubrication (if required)
	Height spindle (Mortising table)	Control and lubrication (if required)
	Guides (Mortising table)	Clean
Every 6 months	Chain (Gearbox)	Check and lubricate if necessary
	Friction wheel (Gearbox)	Check and exchange if necessary
Poorly planed surface	System planer knives	Check and if necessary reverse or replace
	Standard planer knives	Check and if necessary, sharpen or replace



Note: Cleaning and care products are available as accessories.
(See Tools and Accessories catalogue)

10.3 Maintenance work

10.3.1 Checking/cleaning the kickback guards

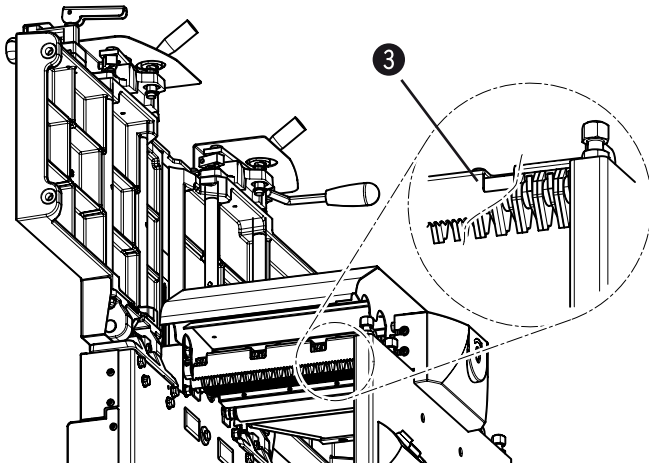

Fig. 10-1: Kickback guards

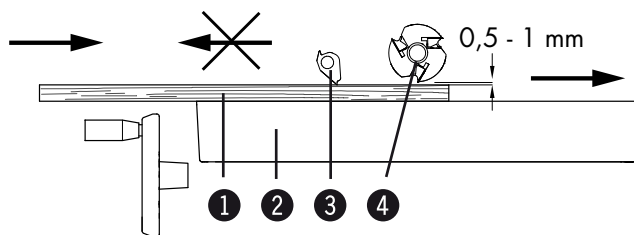

Fig. 10-2: Testing the kickback guards

1. Before beginning any maintenance work on the machine, switch it off and secure it against accidentally being switched on again.
2. Check if functioning: the kickback guards must fall back after having been lifted
3. Check if functioning:
 - Push a planed board into the machine.
 - Adjust the height of the thicknessing table so that there is 0.5 to 1 mm gap between the board and the cutterblock's circle of cut.
 - It should not be possible to pull the board out of the machine.
 - Push the board out of the machine.
4. Remove any resin residue:
 Resin Remover Art. No. 10.0.022 (0,5 l) / 10.0.023 (1,0 l)

- ① Planed board
- ② Thicknesser table
- ③ Kickback guards
- ④ Cutterblock



Note: Should the kickback guards not function properly even after having been cleaned, please contact the HAMMER Service department.

10.3.2 Cleaning the feed rollers

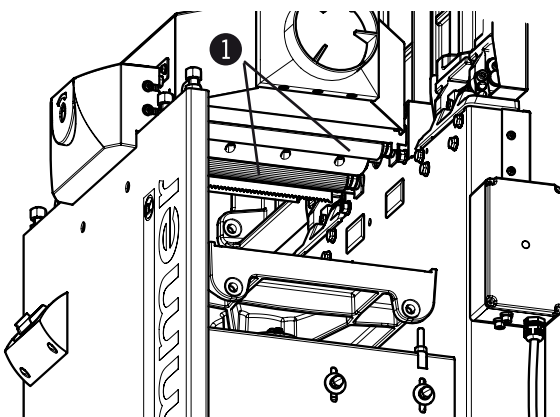

Fig. 10-3: Cleaning the feed rollers

1. Before beginning any maintenance work on the machine, switch it off and secure it against accidentally being switched on again.
2. Remove any resin residue on the feed rollers:
 Resin Remover Art. No. 10.0.022 (0,5 l) / 10.0.023 (1,0 l)

- ① Feed rollers

10.3.3 Greasing the height spindle (thicknesser planing table)

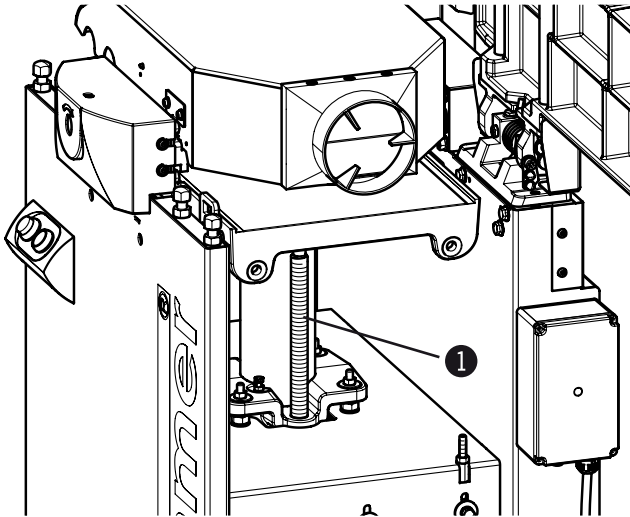

Fig. 10-4: Lubricating the height spindle

1. Before beginning any maintenance work on the machine, switch it off and secure it against accidentally being switched on again.
2. Loosen the clamping lever.
3. Use the system handwheel to move the thicknessing table all the way up
4. Clean the spindles and lubricate with regular machine grease.
5. Use the system handwheel to move the thicknessing table all the way down and then all the way back up again.
6. Clamp the clamping lever.

- ① Thicknesser table height spindle
- ② Lubrication hole
- ③ Single-hand clamping lever

10.3.4 Retensioning the drive belt

Over time, the drive belt will lose its capacity to transmit power. At this point, the drive belt must be re-tensioned or replaced.

The drive belt must be inspected monthly; if tears are discovered, the drive belt must be replaced.

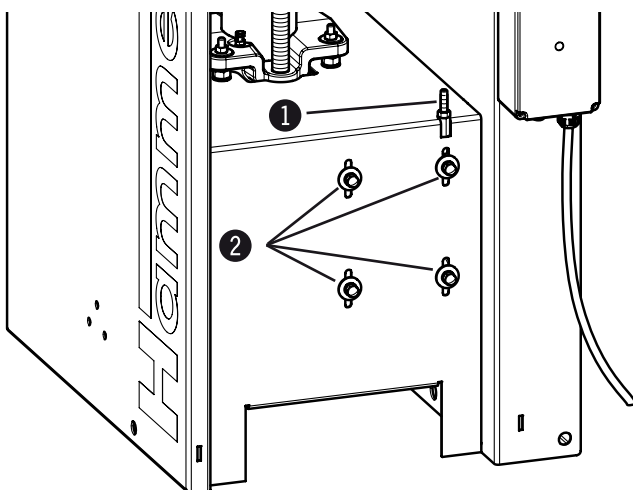

Fig. 10-5: Retensioning the drive belt

1. Before beginning any maintenance work on the machine, switch it off and secure it against accidentally being switched on again
2. Set the gear lever to the "0" setting.
3. Loosen the nuts.
4. Use the belttensioning screw to tension the drive belt.
5. Tighten the nuts

- ① Tightening screw
- ② Nuts



Attention! Risk of material damage!

Do not over-tension the drive belt! Turn the belt-tensioning screw only until the drive belt is sufficiently tensioned to transmit power effectively.

10.3.5 Replacing the drive belt

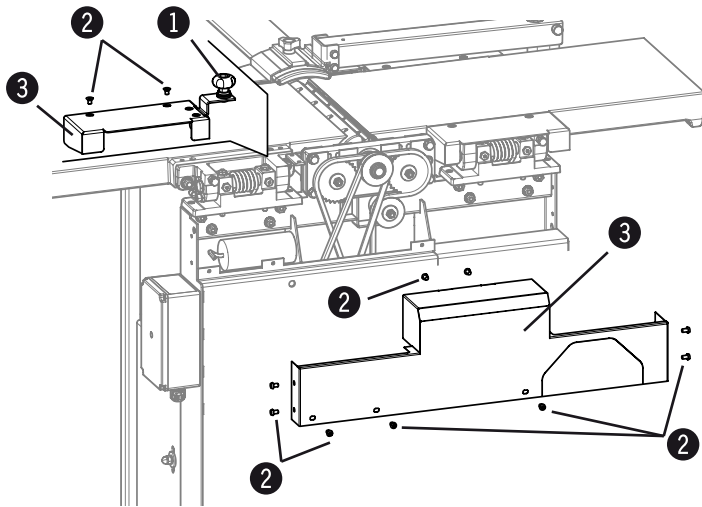

Fig. 10-6: Replacing the drive belt

1. Before beginning any maintenance work on the machine, switch it off and secure it against accidentally being switched on again.
2. Set the gear lever to the "0" setting
Remove the thumb nut
Dismantle the planer fence
3. Loosen the screw and take off the covering lid.

- ① Thumb nut
- ② Screws
- ③ Cover

Replacing the drive belt:

Also see:

10.3.4 Retensioning the drive belt

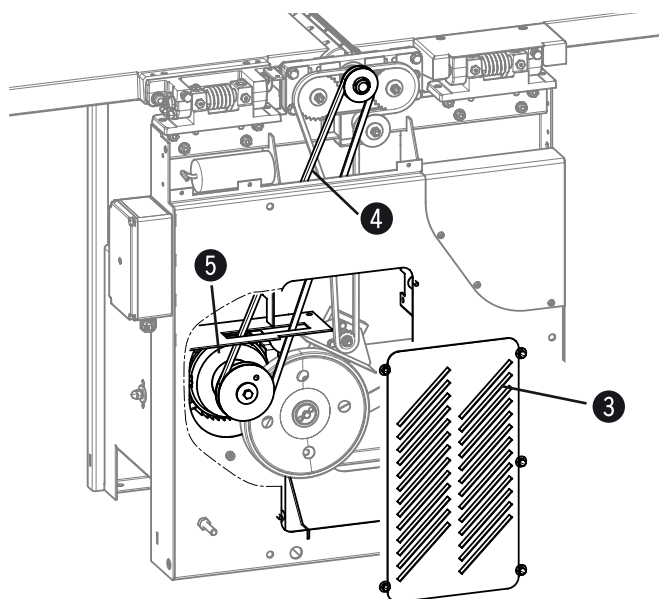

Fig. 10-7: Retensioning the drive belt

4. Loosen the nuts.
5. Remove the old drive belt
6. Hook the new drive belt into place:
 - First hook the belt onto the drive motor (if necessary, open the gearbox cover)
 - Pull up the drive motor with the drive belt
 - Hook the drive belt onto the cutterblock
7. Use the belt-tensioning screw to tension the drive belt.
8. Tighten the nuts
9. Fit and screw the covering lid back on

- ③ Gearbox cover
- ④ Drive belt
- ⑤ Drive motor



Attention! Risk of material damage!

Do not over-tension the drive belt!. Turn the belt-tensioning screw only until the drive belt is sufficiently tensioned to transmit power effectively.

10.3.6 Checking/greasing the chain (transmission)

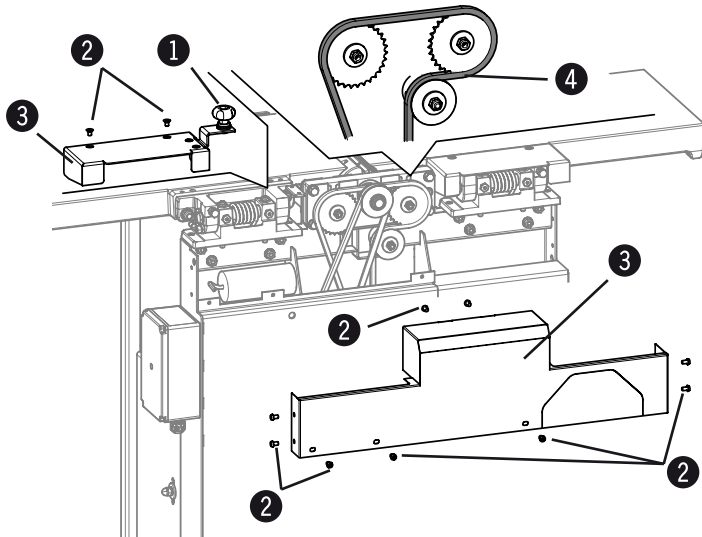

1. Before beginning any maintenance work on the machine, switch it off and secure it against accidentally being switched on again.
2. Set the gear lever to the "0" setting
Remove the thumb nut
Dismantle the planer fence
3. Loosen the screw and take off the covering lid.
4. Check the chain and lubricate with regular machine grease if necessary.
5. Fit and screw the covering lid back on

- ① Thumb nut
- ② Screws
- ③ Cover
- ④ Chain

Fig. 10-8: Checking/greasing the chain (transmission)

10.3.7 Checking/changing the friction wheel (transmission)



Note: The friction wheel is subject to wear. Should the examination reveal a heavily damaged or worn surface, then the friction wheel must be replaced.

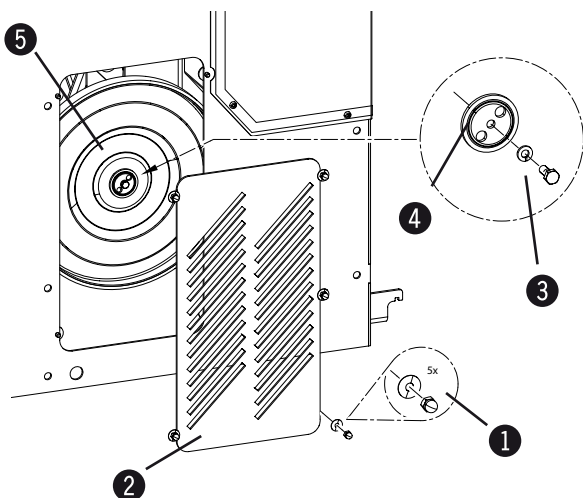

Fig. 10-9: Friction wheel: check/replace

1. Switch the machine off and ensure that it cannot be switched on again.
2. Set the gear lever to the "0" setting.
3. Loosen and remove the hex nuts.
Take off the covering lid
4. Unscrew the screw and remove the spring washer.
5. Remove the thrust plate.
6. Replace the friction wheel.
7. Place the thrust plate back on.
8. Screw the spring washer on.
9. reassemble the cover.

- ① Nuts / Disk spring
- ② Friction wheel
- ③ Screw / Lock washer
- ④ Pressure disk
- ⑤ Gearbox cover

10.3.8 Greasing the height spindle (drilling support)

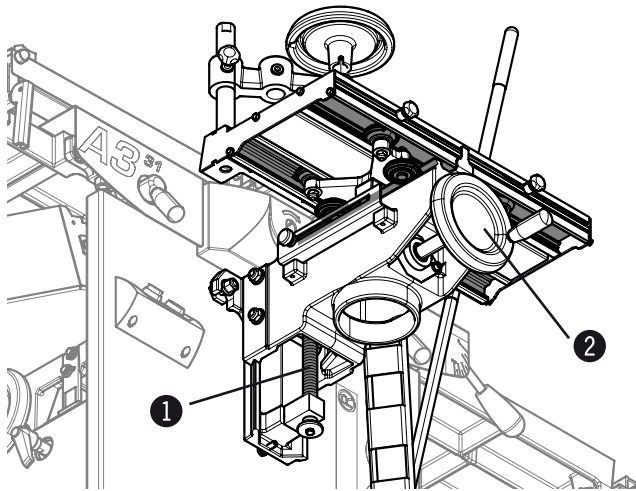

Fig. 10-10: Lubricating the height spindle

1. Before beginning any maintenance work on the machine, switch it off and secure it against accidentally being switched on again.
2. Wipe away old grease residues and remove dust from the spindle.
3. Lubricate the spindle with regular machine grease.
4. Use the system handwheel to move the drilling table all the way up and down.

- ① Spindle
- ② System handwheel

10.3.9 Cleaning the guides (drilling support)

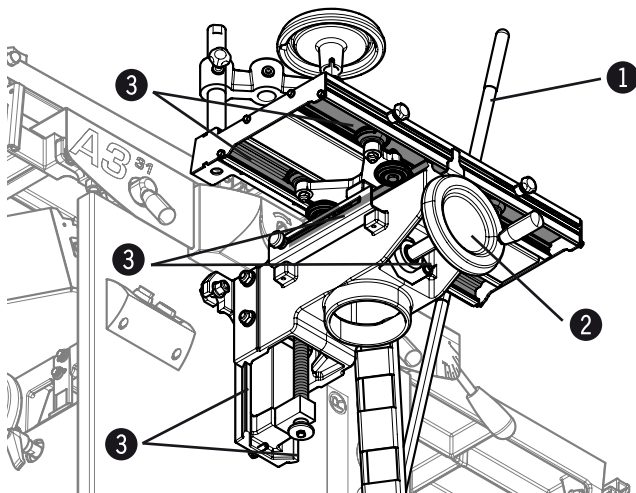

Fig. 10-11: Cleaning the guides

1. Before beginning any maintenance work on the machine, switch it off and secure it against accidentally being switched on again.
2. Use the system handwheel to move the drilling table into the uppermost position
3. Use the one-hand lever to move the mortising table into the front-most position on the left side
4. Clean the guides with a soft cloth.
5. Use the one-hand lever to move the mortising table into the hindmost position on the right side
6. Clean the guides with a soft cloth

- ① Single-hand lever
- ② System handwheel
- ③ Guides



Attention! Do not grease or oil the guides!

11 Faults

11.1 Safety instructions



Warning! Risk of injury! Repairing faults incorrectly can result in personal injury or damage to the machine. For this reason, this work may only be carried out by authorised, trained personnel who are familiar with how to operate the machine and in strict observance of all safety instructions.



Warning! Danger! Electric current:
Work on electrical fittings may only be carried out by qualified personnel and in strict observance of the safety instructions.

11.2 What to do if a fault develops

In most cases:

- 1.** In the event of problems which may present a danger to people, objects or operational safety, stop the machine immediately using the red OFF button.
- 2.** Also disconnect the machine from the mains and ensure it can not be switched on again.
- 3.** Inform those responsible for machine faults immediately.
- 4.** Type and extent of fault should be determined by an authorised professional, as well as the cause and repair.

11.3 What to do after rectifying the fault



Warning! Risk of injury!
Repairing faults incorrectly can result in personal injury or damage to the machine.

Before switching the machine back on

- The fault and its cause are professionally repaired.
- All safety equipment has been assembled according to regulations and is working correctly.
- Individuals are not located within the danger area of the machine.

Faults

11.4 Faults, causes and repairs

Fault	Cause	Repair
Machine does not start	Main switch at setting „0“	Check switch position
	Planer tables and/or vacuum hood incorrectly positioned (Safety break switch is not activated)	Close planer tables properly and position the vacuum hood correctly
Squeaking noises when starting up	Insufficient tension (Drive belt)	Retensioning the drive belt
The joint is not true (extremely splayed or open joint)	Receiver-side of the planer table is misaligned	Adjusting the joint Replace the planer knives* 1)
	Planer knives are worn out	Replace the planer knives* 1)
When surface planing, workpiece stops at the receiver-side of the planer table	Receiver-side of the planer table is too high in relation to the circle of cut	Adjusting the joint Replace the planer knives* 1)
„Straight cut“ at the end of the workpiece when surface planing	Receiver-side of the planer table is too low in relation to the circle of cut	Adjusting the joint Replace the planer knives* 1)
The planer fence angle is not correct	Angle setting misadjusted	Correcting the angle of the planing fence
Unsatisfactory planing result	System planer knife	Check and if necessary reverse or replace
	Standard planer knives	Check and if necessary, sharpen or replace
„Straight cut“ at the beginning of the workpiece when thickness planing	Insufficient spring pressure on the feeder-side (corrugated) feed roller	Adjusting the feed rollers* 2)
„Straight cut“ at the end of the workpiece when thickness planing	Insufficient spring pressure on the extraction-side (smooth) feed roller	Adjusting the feed rollers* 2)
„Oblique cut“ at the beginning of the workpiece when thickness planing	Insufficient spring pressure on one side of the feeder-side (corrugated) feed roller	Adjusting the feed rollers* 2)
„Oblique cut“ at the end of the workpiece when thickness planing	Outfeed roller (smooth) spring pressure too low on one side	Adjusting the feed rollers* 2)

*1) System planer knives Reverse or replace
Standard planer knives Sharpen or replace
Adjusting the joint

*2) Contact service technician

11.5 Resharpen or replace the planer knife



Note: Checking the joint adjustment
Reverse or replace the planer knives once the planing results are no longer satisfactory.
See Chapter >8.3 Adjusting the joint<!



Note:
Only use original HAMMER planer knives!

System planer knives	260	310	410
Cobalt HS – 3 pcs.	500-07-011	500-07-002	500-07-005
Chrome steel (SS) – 3 pcs.	500-07-010	500-07-001	500-07-004

Standard planer knives	260	310	410
Cobalt HS – 1 pcs.	500-07-006	500-07-007	500-07-008
Tungsten carbide (HW) – 1 pcs.	07.4.226	07.4.231	07.4.241

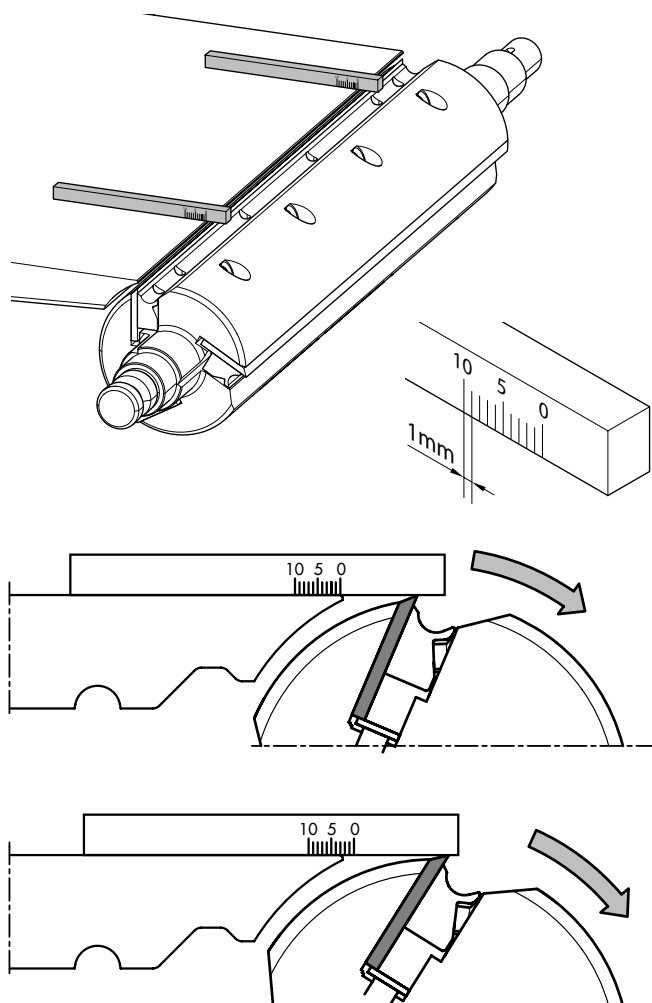

In the event of poor planing results, turn the planer knives (system knives), sharpened (re-usable knives) or replace.

Checking the planer knives:

1. Prepare two gauges according to the illustration opposite.
2. Set the gauges at "0" on the outfeed side of the planer table edge on the left and right ends of the cutterblock.
3. Turn the cutterblock manually.
4. The planer knife should move the gauges 2 to 3 mm (Manufacturer's settings).
5. Should the setting not be correct:
See Chapter >8.3 Adjusting the joint<

Checking the joint adjustment:

It may be necessary to readjust the joint if the planer knives have been changed or replaced.
See Chapter >8.3 Adjusting the joint<

Fig. 11-1: Planer knife check

11.5.1 Reversing/replacing the system planer blades



Attention! Risk of injury!

The planer knives are razor sharp. Handle the planer knives with the utmost care, especially when turning the cutterblock by hand.



Attention!

Execute the following instructions exactly!

Always tighten the knife holder screws from the inside to the outside.

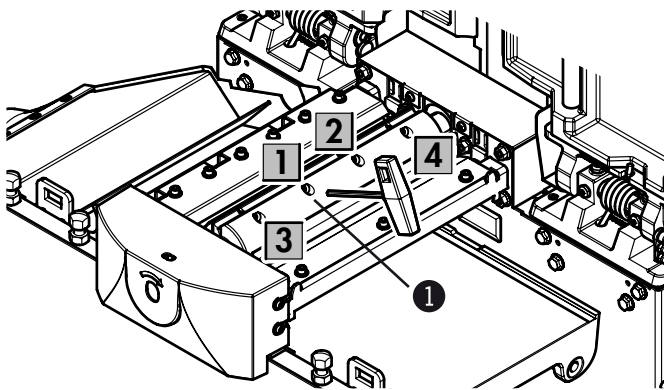

Fig. 11-2: Reversing/replacing the system planer blades

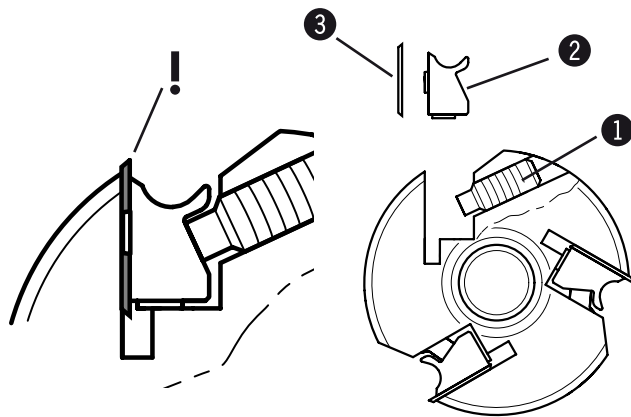

Fig. 11-3: Assembling position

1. Before beginning any maintenance work on the machine, switch it off and secure it against accidentally being switched on again.
2. Both planer tables must be tilted up and secured with the fall locks.
3. Remove all the blade-holder screws from one planer knife.
4. Remove the knife holder and planer knife.
5. Clean resin residues thoroughly from the planer knife, knife base and cutterblock. Use resin remover art. no. 10.0.002 (0.5l) or 10.0.023 (1l).
6. Reverse the planer knife (if only one cutting edge ' is worn)
7. Insert the planer knife (reversed or new) and the knife holder again.
8. First, gently tighten all the blade-holder screws.
9. Tighten all the knife holder screws (minimum torque 15 Nm).
10. Repeat steps 3 to 9 for the other planer knives.

- ① Blade-holder screws
- ② Blade holder
- ③ Planer knife



Attention! Risk of material damage!

Do not clean with compressed air! Ensure that the planer knife is positioned correctly!



Note: Checking the joint adjustment

It may be necessary to readjust the joint if the planer knives have been changed or replaced.
 See Chapter >8.3 Adjusting the joint<

11.5.2 Sharpening/changing the standard planer knives



Attention! Risk of injury!

The planer knives are razor sharp. Handle the planer knives with the utmost care, especially when turning the cutterblock by hand.



Attention!

Execute the following instructions exactly!

Always tighten the knife holder screws from the inside to the outside.

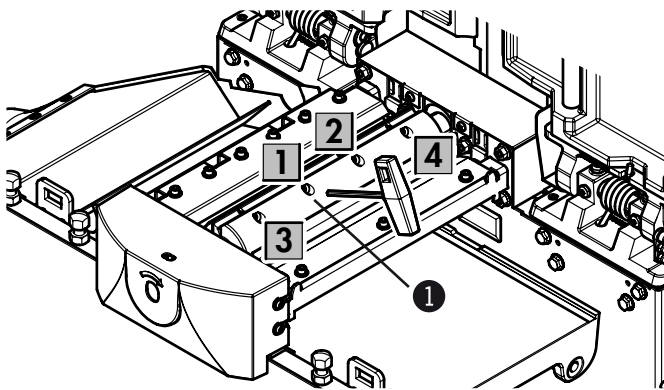

Fig. 11-4: Sharpening/changing the standard planer knives

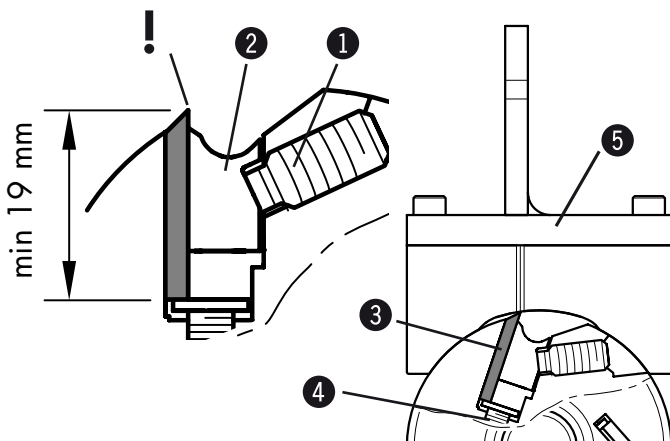

Fig. 11-5: Assembling position

1. Before beginning any maintenance work on the machine, switch it off and secure it against accidentally being switched on again.
2. Both planer tables must be tilted up and secured with the fall locks.
3. Remove all the blade-holder screws from one planer knife.
4. Remove the knife holder and planer knife.
5. Clean resin residues thoroughly from the planer knife, knife base and cutterblock. Use resin remover art. no. 10.0.002 (0.5l) or 10.0.023 (1l).
6. Resharpen or replace the planer knife.
7. Insert the planer knife and knife holder again. First, gently tighten all the blade-holder screws.
8. Place the adjustment device onto the cutterblock so that the planer knife points towards the marking. The planer knives are pushed towards the top by the adjustment springs.
9. Tighten all the knife holder screws (minimum torque 15 Nm).
10. Repeat steps 3 to 9 for the other planer knives.

- ① Blade-holder screws
- ② Blade holder
- ③ Planer knife
- ④ Adjustment spring
- ⑤ Adjustment device
- ⑥ Marking



Attention! Risk of material damage!

Do not clean with compressed air! Ensure that the planer knife is positioned correctly!



Note: Checking the joint adjustment

It may be necessary to readjust the joint if the planer knives have been changed or replaced. See Chapter >8.3 Adjusting the joint<

11.6 Correcting the angle of the planing fence

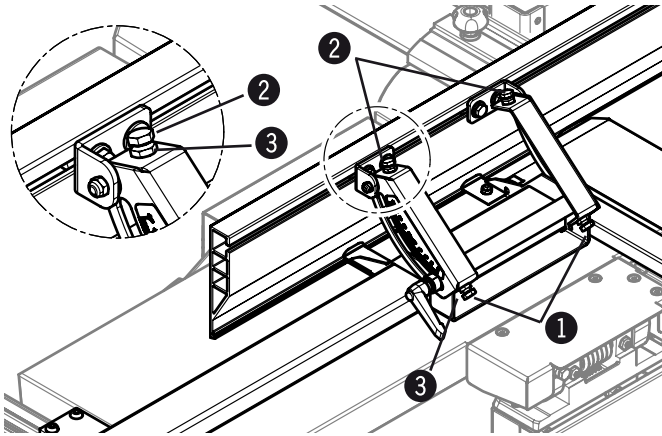

Fig. 11-6: Correcting the angle of the combination fence

1. Before beginning any maintenance work on the machine, switch it off and secure it against accidentally being switched on again.
2. Loosen the clamping lever.
3. Loosen the lock nuts.
4. Position a sample workpiece or right angle against the combination fence
5. adjust the fence screws
6. Tighten the lock nuts.
7. Test the adjustment and if required, readjust.

- ① fence screws - 90°
- ② fence screws - 45°
- ③ Lock nut

12 Index

- 2**
2-jaw drilling chuck, 19
- A**
Accessories, 19
Adjust the thicknessing height, 35
Adjusting the combination fence, 34
Adjusting the depth of cut, 32
Adjusting the drilling support, 36
Adjusting the feed rollers, 59
Adjusting the joint, 33
Adjusting the rear cutterblock cover, 34
Alternating-current motor, 31
Assembly, 18
- B**
Bevelling, 47
Break switch, 22
Bridge guard, 18, 22
- C**
Changes to the machine, 9
Chip extraction, 15, 30
Chuck, 19
Clamp the drilling tool, 39
Combination fence, 18
Copyright, 7
Correcting the angle of the combination fence, 67
Coupler unit, 19
Cutterblock cover, 18, 23
Cutterblock, 16
- D**
Dangers, 11
Data plate, 21
Declaration of Conformity, 13
Digital clock, 19
Dimensions, 14
Display elements, 24
Disposal, 8
Drilling chuck guard, 23
Drilling unit, 17
Drilling, 50
Drive motor, 15
- E**
EMERGENCY-STOP, 42
Electrical connection, 14, 31
Equipping, 32
- F**
Faults, 58
- H**
Hearing protection, 11
- I**
Intended use, 9
- J**
Jointing, 46
- K**
Kickback guards, 23, 53
- L**
Liability, 7
Lifting bar, 20
- M**
Maintenance schedule, 52
Maintenance work, 53
Making adjustments and preparations, 32
Modifications to the machine, 9
Mortising table, 17, 19
- N**
Noise emission, 16
- O**
Operating conditions, 15, 28
Operating manual, 6, 9
Operation and display elements, 24
Operation, 41
Operator, 10
Other risks, 12
Overview, 18
- P**
Packaging, 27
Particle emission, 15
Protective footwear, 11
Protective gear, 11
- Q**
Qualified personnel, 10
- R**
Rear cutterblock cover, 23
Retooling from a planer to a thicknesser, 37
Retooling from a thicknesser to a planer, 38
Retooling to the drilling unit, 39
Rolling carriage, 20

Index

S

Safety at work, 41
Safety break switches, 22
Safety devices, 22
Safety during equipping, 32
Safety during installation, 28
Safety during maintenance, 52
Safety during repairs, 58
Safety during setup, 32
Safety during transport, 25
Safety, 9
Service, 57
Setup, 28
Spare parts, 7
Specifications, 14
Staff, 10
Storage conditions, 15
Storage, 25
Surface planing, 43
Switching off the machine, 42
Switching on the machine, 42
Symbol legend, 6

T

Table extension, 20
Tapering, 47
Thickness planing, 48
Thicknesser unit, 17, 18
Three-phase alternating current motor, 31
Transport inspection, 27
Transport, 25

V

Vacuum hood, 18

W

Warranty notice, 7
Warranty, 7
Weight, 14
Work clothing, 11
Work safety, 10
Working techniques, 43, 48, 50

Hammer®

KR-FELDER-STR. 1

A-6060 Hall in Tirol

Tel.: +43 (0) 52 23 / 45 0 90

Fax.: +43 (0) 52 23 / 45 0 99

Email: info@hammer.at

Internet: www.hammer.at

ORDER-FAX
+43 5223 45 0 99



Tel. hotline
+43 5223 45090



E-mail
info@hammer.at

Order No.	Article Description	Pcs.



☐ **YES,** send me the new
HAMMER-catalog.

First Name

Name/Company Name

Street + House-No.

Important: For company orders - please provide the VAT registration number!

Phone No. (Area Code)

Post Code/City

Mobile No. (Code)

Fax No. (Area Code)

Availability (time)

☐ Yes, please send me your Newsletter.

Email Address

Send to my address, subject to your delivery and payment conditions:

Date:

Signature:

Hammer
WARRANTY

In this position is your Warranty Card!

After sending in your warranty card you will
receive:

A certificate of the expanded HAMMER warranty!

HAMMER-Info-Zentrum

Tel.: (A) 0 52 23 / 45 0 90
Fax: (A) 0 52 23 / 45 0 99
Email: info@hammer.at
http://www.hammer.at

Business hours:

Mo. - Fr.: 09⁰⁰ - 12⁰⁰
13⁰⁰ - 17⁰⁰
Sa.: 09⁰⁰ - 11³⁰

Please stamp

Hammer-Info-Zentrum

KR-FELDER-STR. 1

A-6060 HALL in Tirol
Austria

First Name	Name/Company Name
	Important: For company orders - please provide the VAT registration number!
Street + House-No.	Post Code/City
Phone No. (Area Code)	Fax No. (Area Code)
Mobile No. (Code)	Availability (time)

☐ Yes, please send me your Newsletter.

Email Address	@
---------------	---

Please fill in the following information from your data plate on your machine:

Machine type:	Machine Number:
Electrical Equipment:	V PH Hz KW A Year of Manufacture
Received on:	Machine was bought from:
Machine Location:	<input type="checkbox"/> Cellar / basement <input type="checkbox"/> First or ground floor <input type="checkbox"/> Loft / Attic
Machine set-up and training was completed by:	<input type="checkbox"/> HAMMER- Qualified personnel! <input type="checkbox"/> HAMMER- Operation manual

☐ **YES,** send me the new HAMMER-catalog.